

Land Title Act 1994 ; Land Act 1994
Form 21 Version 4

SURVEY PLAN

Sheet 1 of 11

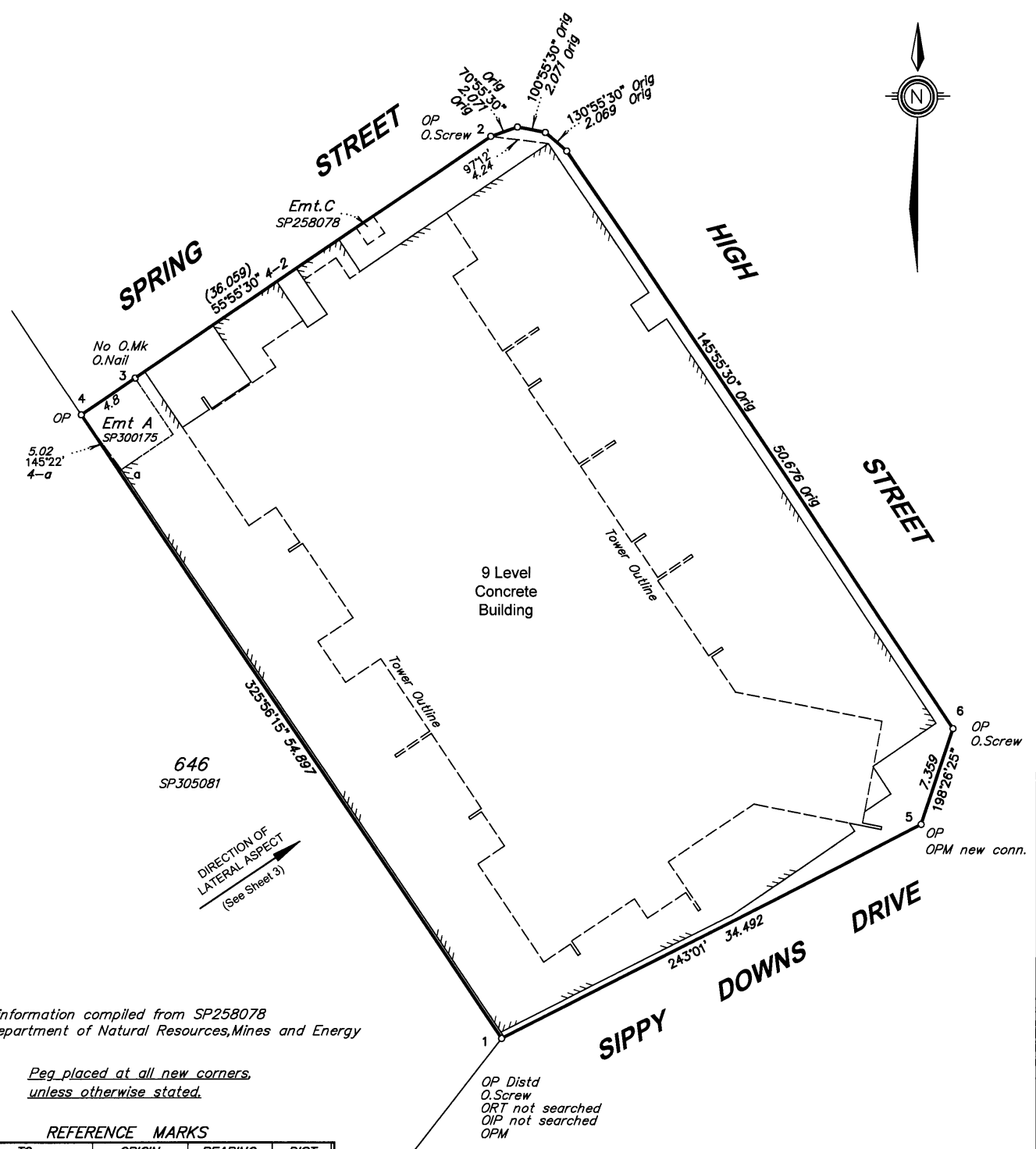

Original information compiled from SP258078 in the Department of Natural Resources, Mines and Energy

Peg placed at all new corners, unless otherwise stated.

REFERENCE MARKS

STN	TO	ORIGIN	BEARING	DIST
1	O.Screw in kb	2/SP305081	164°57'30"	11.745
1	OIP	4/RP132099	145°56'	1.006
1	ORT	4/RP132099	331°14'	3.52
2	O.Screw in kb	17/SP258078	323°42'	5.998
3	O.Nail in kb	3/SP300175	10°17'	8.681
6	O.Screw in kb	19/SP258078	338°09'35"	17.83

not searched
not searched

Area of Base Parcel
2280m²

PERMANENT MARKS

PM	ORIGIN	BEARING	DIST	NO
1-OPM	2/SP258078	199°40'20"	94.454	189388
5-OPM	1/SP258078	76°20'45"	39.452	189387

New Conn

I, David Neil BAKER hereby certify that the land comprised in this plan was surveyed by me personally and that the plan is accurate, that the said survey was performed in accordance with the Survey and Mapping Infrastructure Act 2003 and Surveyors Act 2003 and associated Regulations and Standards and that the said survey was completed on 9-8-19

[Signature]
Cadastral Surveyor

Date 12-8-2019

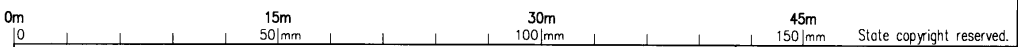

Plan of Lots 101-104, 201-210, 301-310, 401-410, 501-510, 601-610, 701-710, 801-808 & Common Property

Cancelling Lot 3 on SP258078

LOCAL GOVERNMENT: SUNSHINE COAST REGIONAL COUNCIL LOCALITY: SIPPY DOWNS

Meridian: SP258078

Survey Records: No

Scale: 1:300
Format: BUILDING

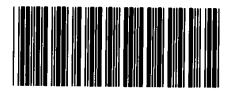

SP290655

**WARNING : Folded or Mutilated Plans will not be accepted.
Plans may be rolled.
Information may not be placed in the outer margins.**

719660222

\$7655.00
04/10/2019 12:51

BE 400 NT

5. Lodged by

Shand Taylor Lawyers
GPO Box 2436, Brisbane 4001 BE 196A
07 3307 4500

(Include address, phone number, reference, and Lodger Code)

1. Certificate of Registered Owners or Lessees.

I/We HABITAT DEVELOPMENT GROUP PTY LTD
A.C.N. 002 615 741 TRUSTEE
UNDER INSTRUMENT 711395706

(Names in full)

* as Registered Owners of this land agree to this plan and dedicate the Public Use Land as shown hereon in accordance with Section 50 of the Land Title Act 1994.

* as Lessees of this land agree to this plan.

[Signature] DIRECTOR
[Signature] DIRECTOR
Signature of * Registered Owners * Lessees

Existing		Created		
Title Reference	Description	New Lots	Road	Secondary Interests
50999720	Lot 3 on SP258078	101-104, 201-210, 301-310, 401-410, 501-510, 601-610, 701-710, 801-808 & CP		

ENCUMBRANCE EASEMENT ALLOCATIONS

Easement	Lots to be Encumbered
716649238 (Emt C on SP258078)	Common Property
719432037 (Emt A on SP300175)	Common Property

MORTGAGE ALLOCATIONS

Mortgage	Lots Fully Encumbered	Lots Partially Encumbered
715373421	101-104, 201-210, 301-310, 401-410, 501-510, 601-610, 701-710 & 801-808	

* Rule out whichever is inapplicable

2. Planning Body Approval.

* SUNSHINE COAST REGIONAL COUNCIL
hereby approves this plan in accordance with the :
% PLANNING ACT 2016

Reinstatement report

All measurements in agreement with SP258078

Development Approval : 29-7-16

Dated this SECOND day of OCTOBER, 2019

[Signature] #
DELEGATED OFFICER
RICHARD MACGILLIVRAY
COORDINATOR, ENGINEERING & ENVIRONMENT #
ASSESSMENT UNIT
SUNSHINE COAST REGIONAL COUNCIL

* Insert the name of the Planning Body. % Insert applicable approving legislation.
Insert designation of signatory or delegation

101-104, 201-210, 301-310, 401-410, 501-510, 601-610, 701-710, 801-808 & CP	Por.351
Lots	Orig

9. Building Format Plans only.

I certify that :
* As far as it is practical to determine, no part of the building shown on this plan encroaches onto adjoining lots or road;
~~* Part of the building shown on this plan encroaches onto adjoining lots and road~~
[Signature] 12-8-19
Cadastral Surveyor/Director * Date
*delete words not required

10. Lodgement Fees :

Survey Deposit \$
Lodgement \$
..... New Titles \$
Photocopy \$
Postage \$
TOTAL \$

11. Insert Plan Number
SP290655

3. Plans with Community Management Statement :

CMS Number : 53071
Name : 'One Tree' CTS

4. References :

Dept File :
Local Govt : PCSA/6208
Surveyor : 180506

7. Orig Grant Allocation :

8. Passed & Endorsed :

By : DNRME
Date : 3/10/2019
Signed : *[Signature]*
Designation : CADASTRAL SURVEYOR

LEVEL A

Scale 1:250

Emt A
SP300175

Emt.C
SP258078

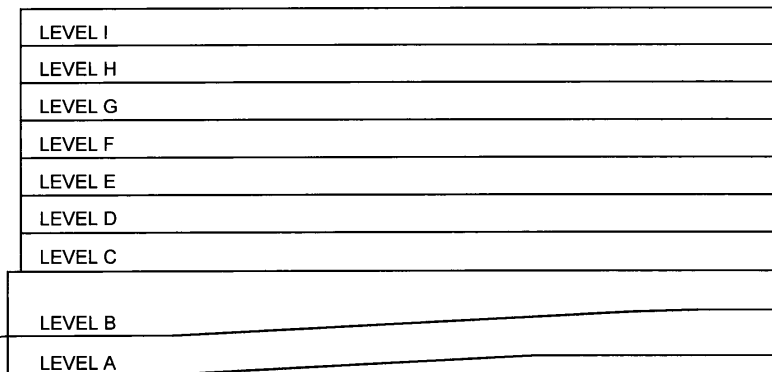
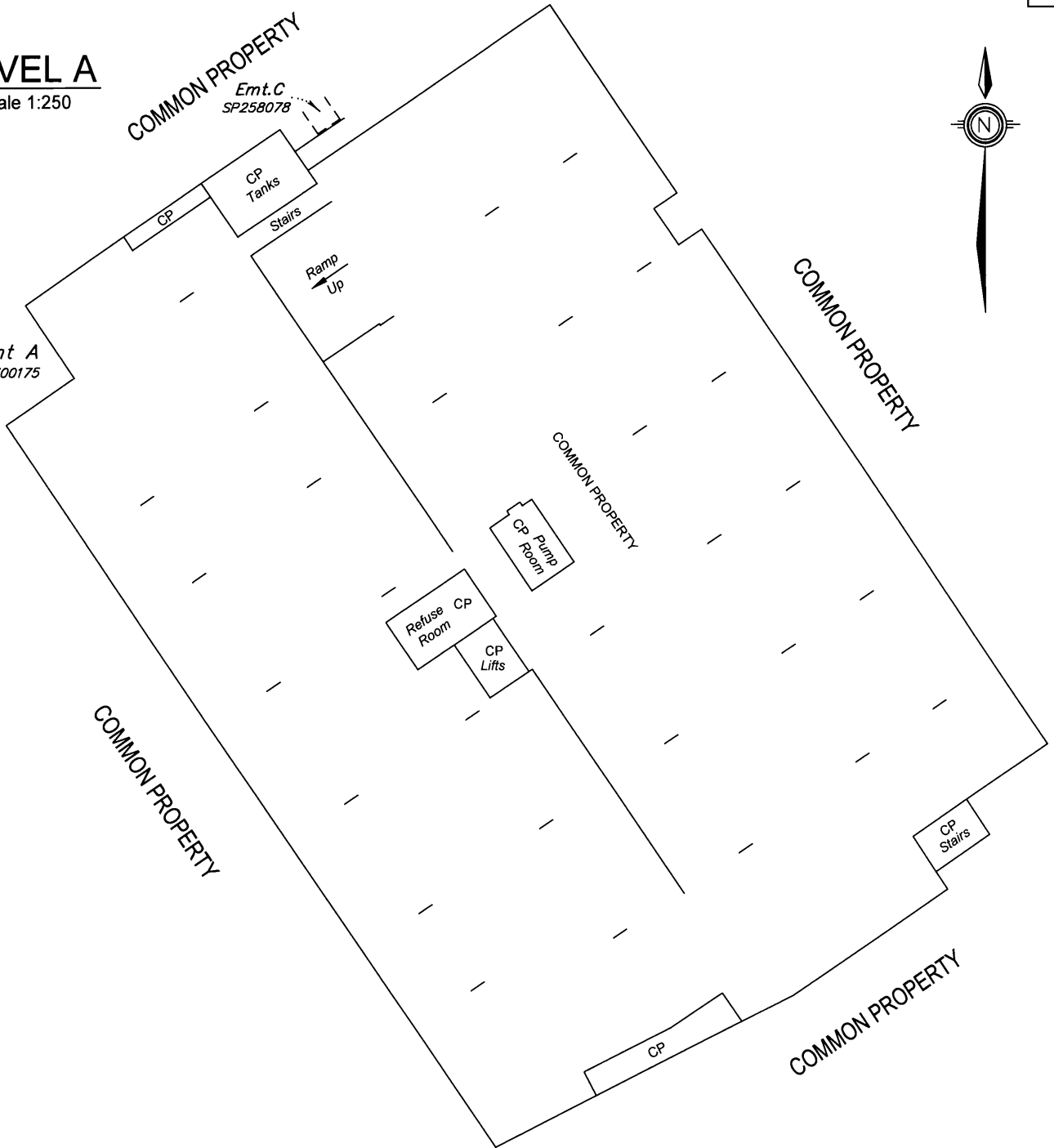

LATERAL ASPECT

(Viewed from the South West)

Scale 1:400

Scale 1:250 - Lengths are in Metres.

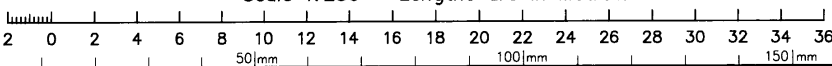

State copyright reserved.

Insert
Plan
Number

SP290655

LEVEL C

Scale 1:250

 DENOTES LEVEL BELOW

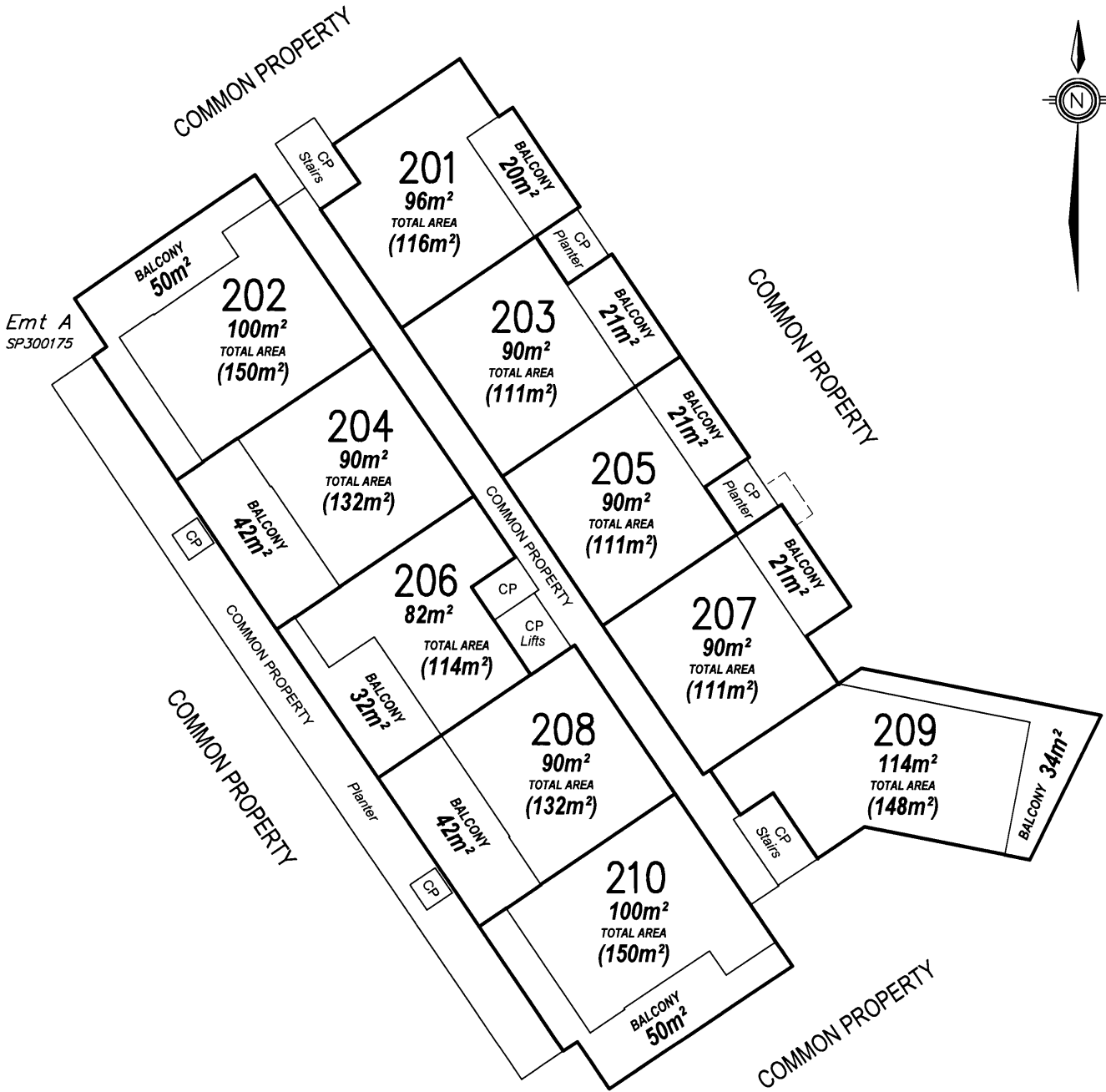

Scale 1:250 – Lengths are in Metres.

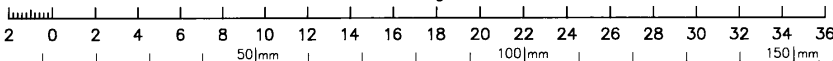

State copyright reserved.

Insert Plan Number SP290655

LEVEL D

Scale 1:250

 DENOTES LEVEL BELOW

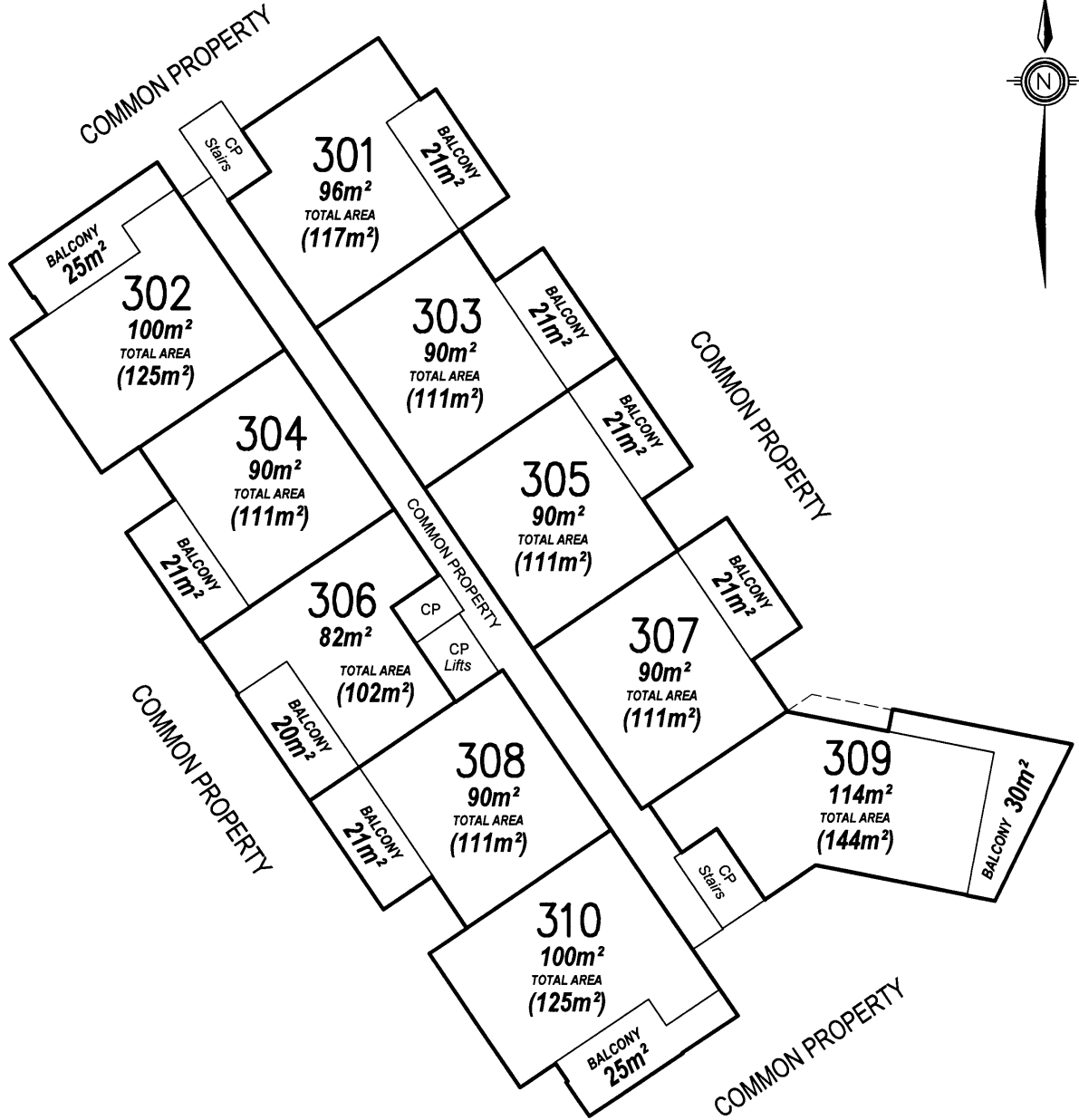

Scale 1:250 - Lengths are in Metres.

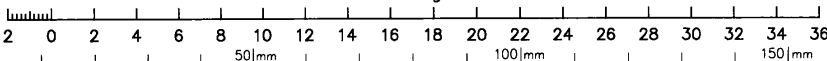

State copyright reserved.

Insert Plan Number SP290655

LEVEL E

Scale 1:250

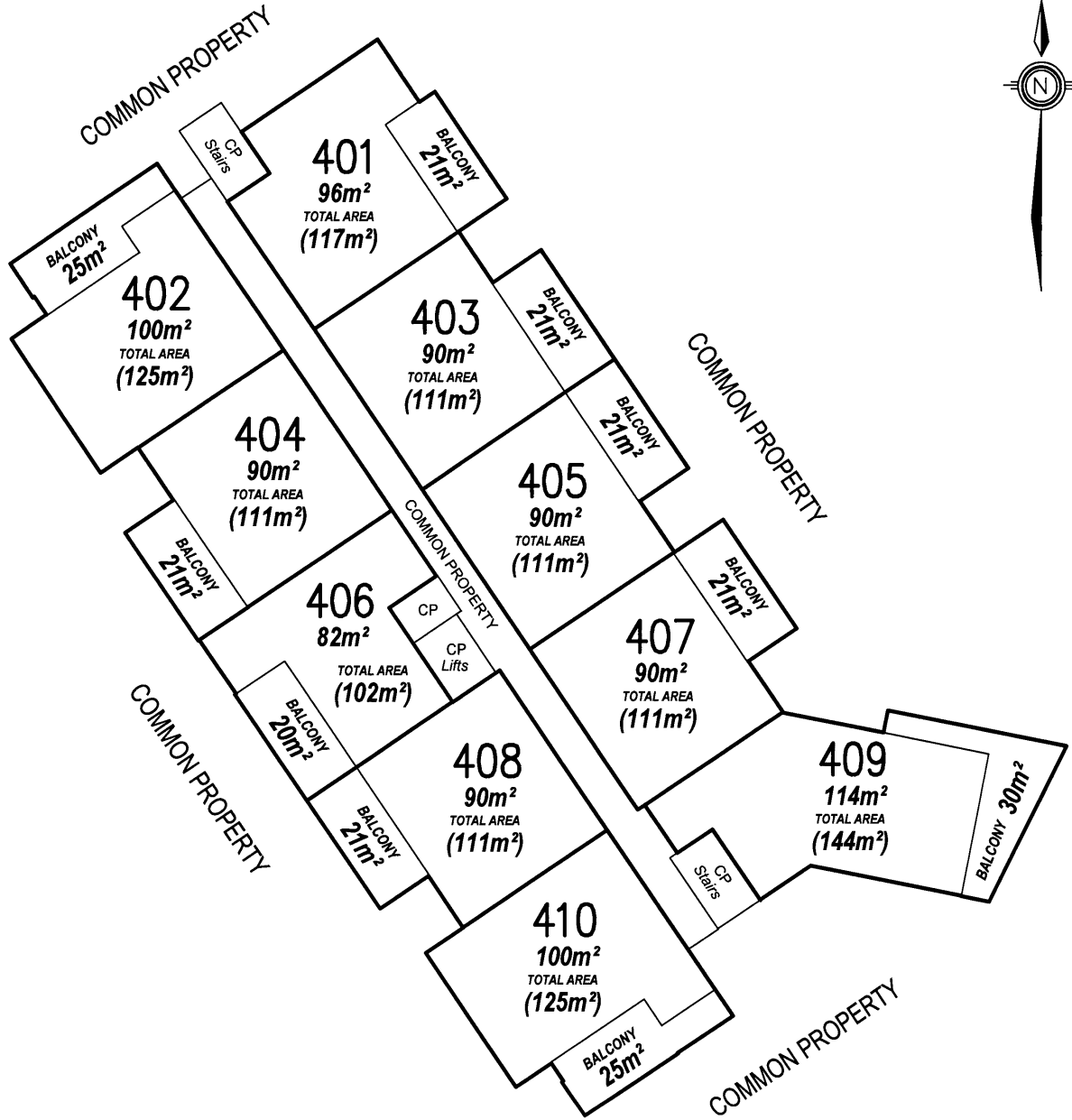

Scale 1:250 - Lengths are in Metres.

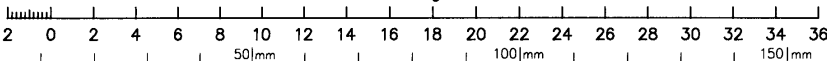

State copyright reserved.

Insert Plan Number SP290655

LEVEL F

Scale 1:250

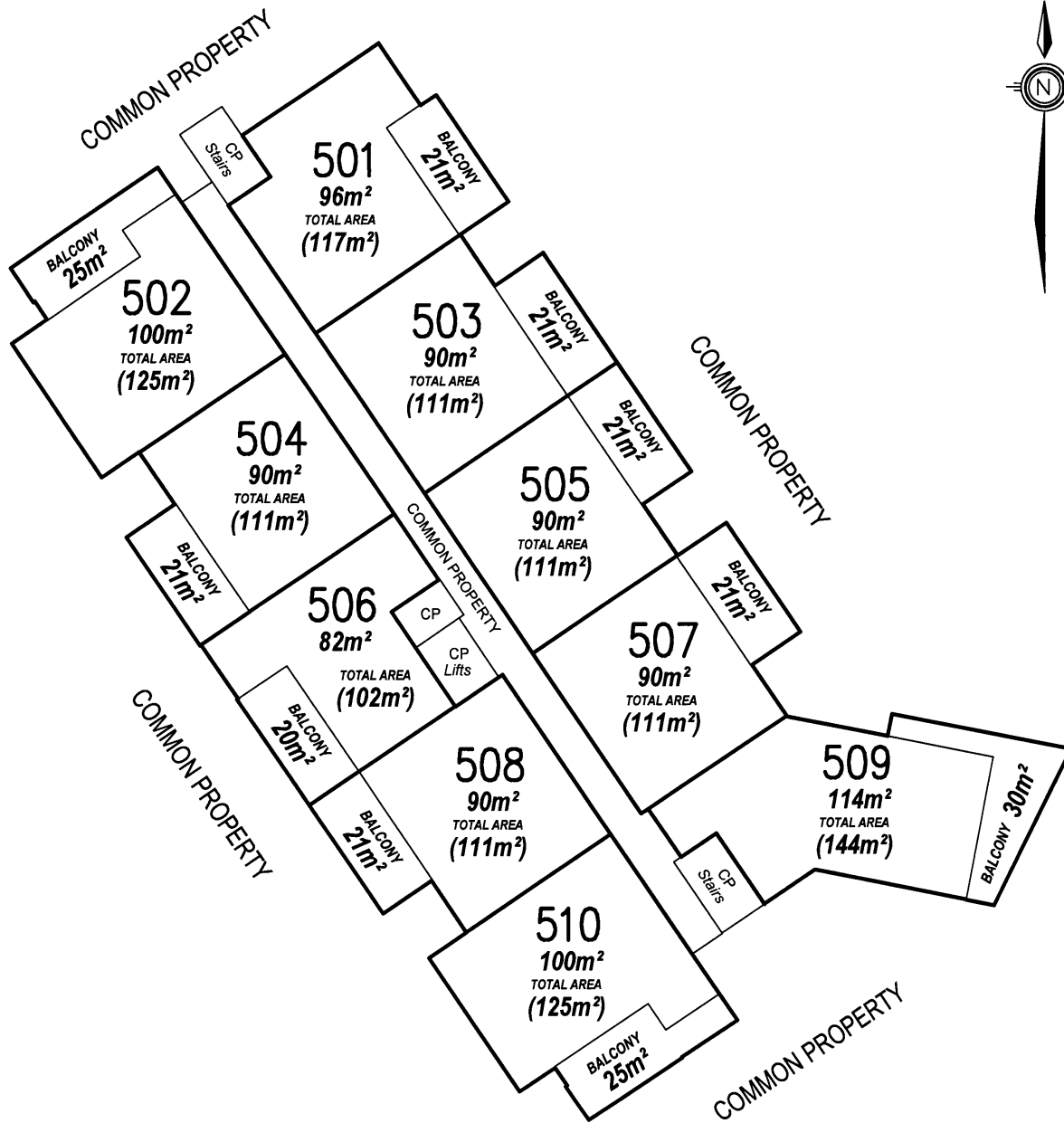

Scale 1:250 - Lengths are in Metres.

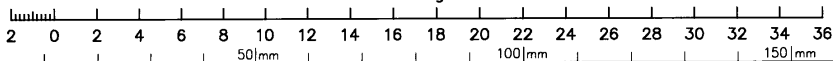

State copyright reserved.

Insert
Plan
Number

SP290655

LEVEL G

Scale 1:250

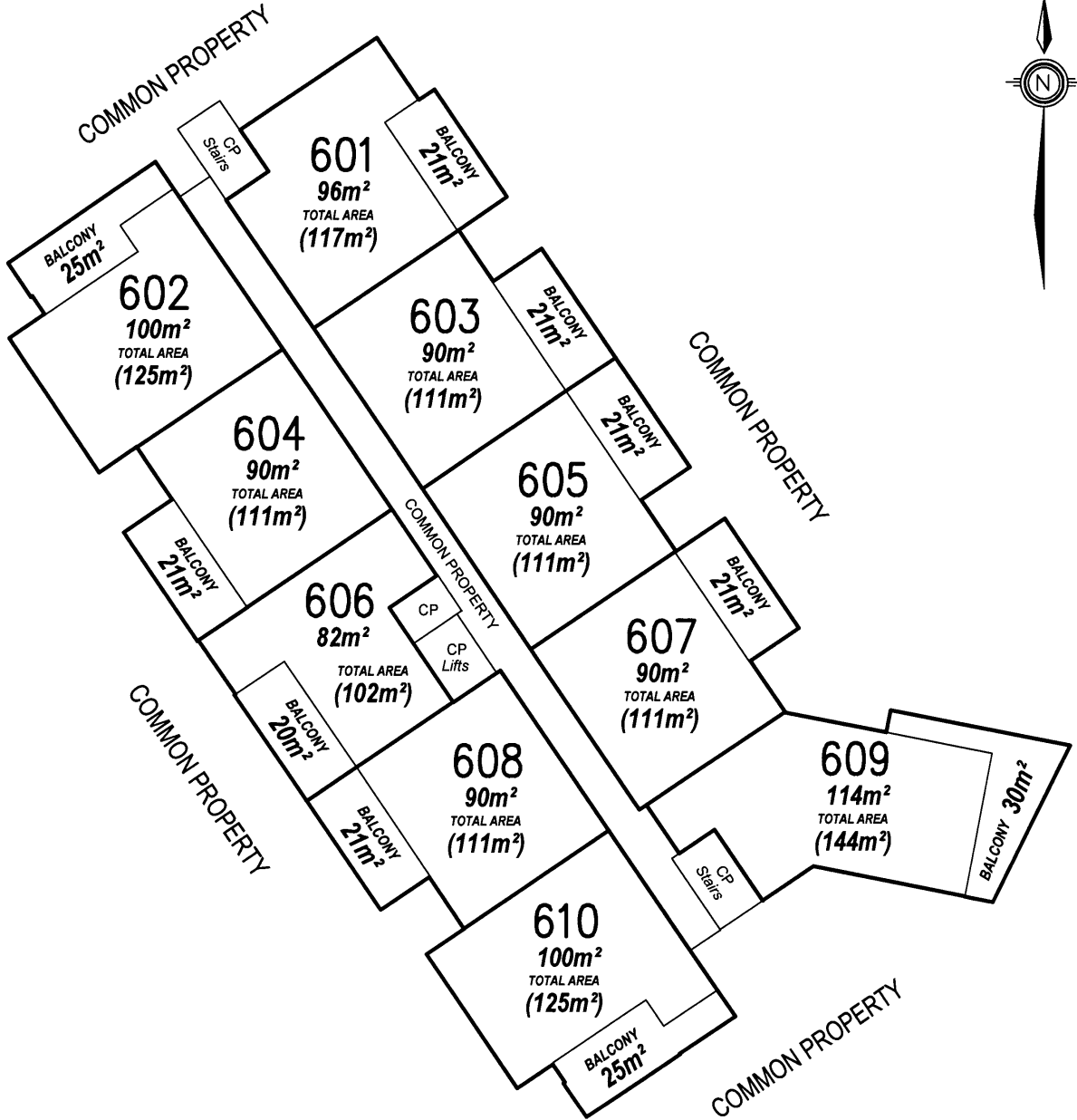

Scale 1:250 - Lengths are in Metres.

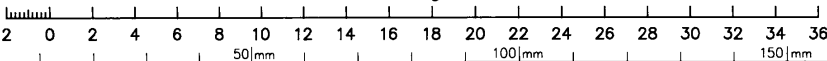

State copyright reserved.

Insert Plan Number SP290655

LEVEL H

Scale 1:250

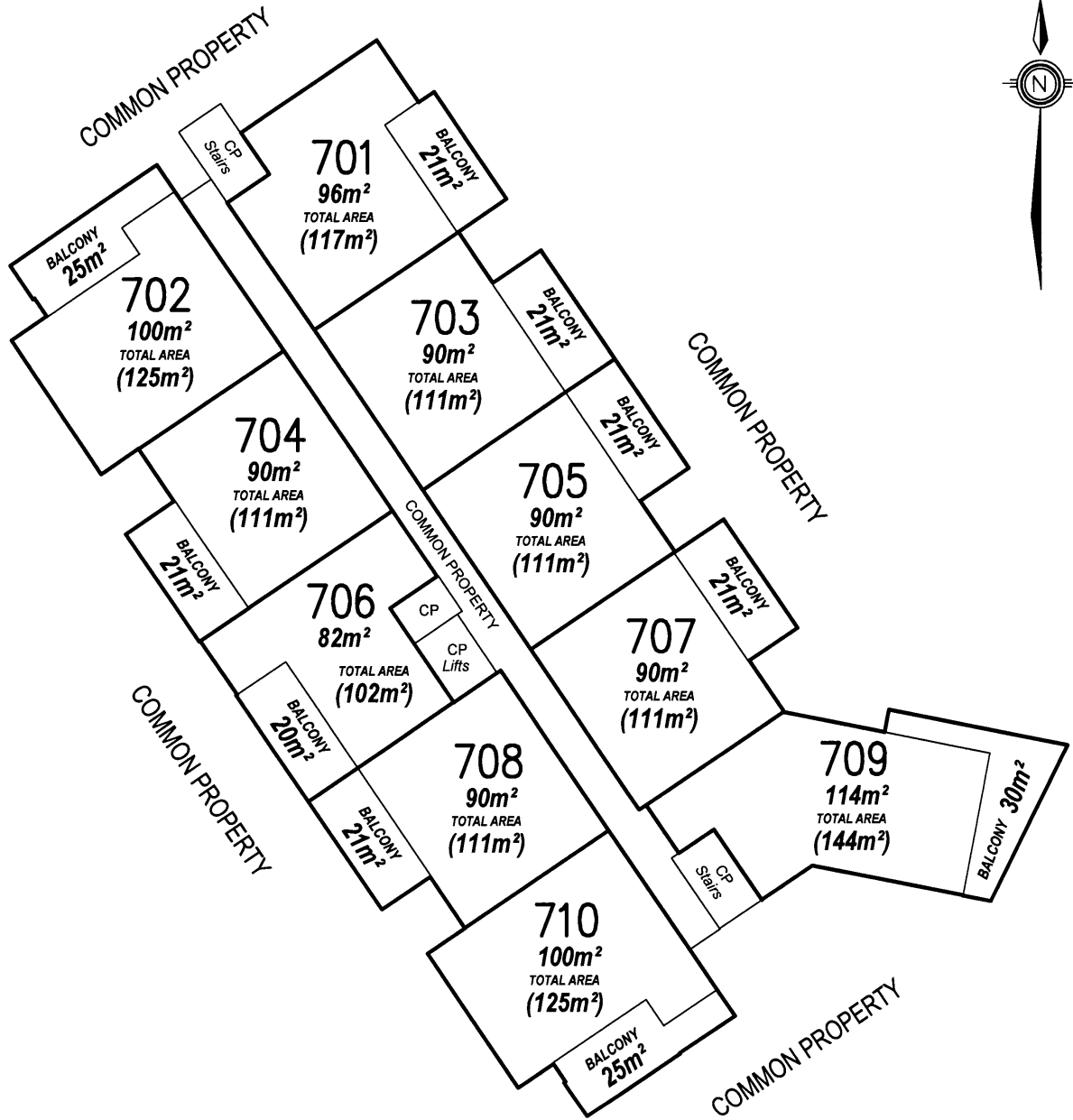
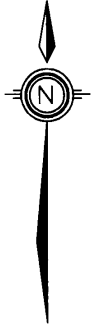

Scale 1:250 - Lengths are in Metres.

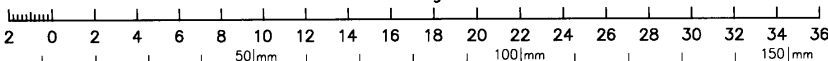

State copyright reserved.

Insert
Plan
Number

SP290655

LEVEL I

Scale 1:250

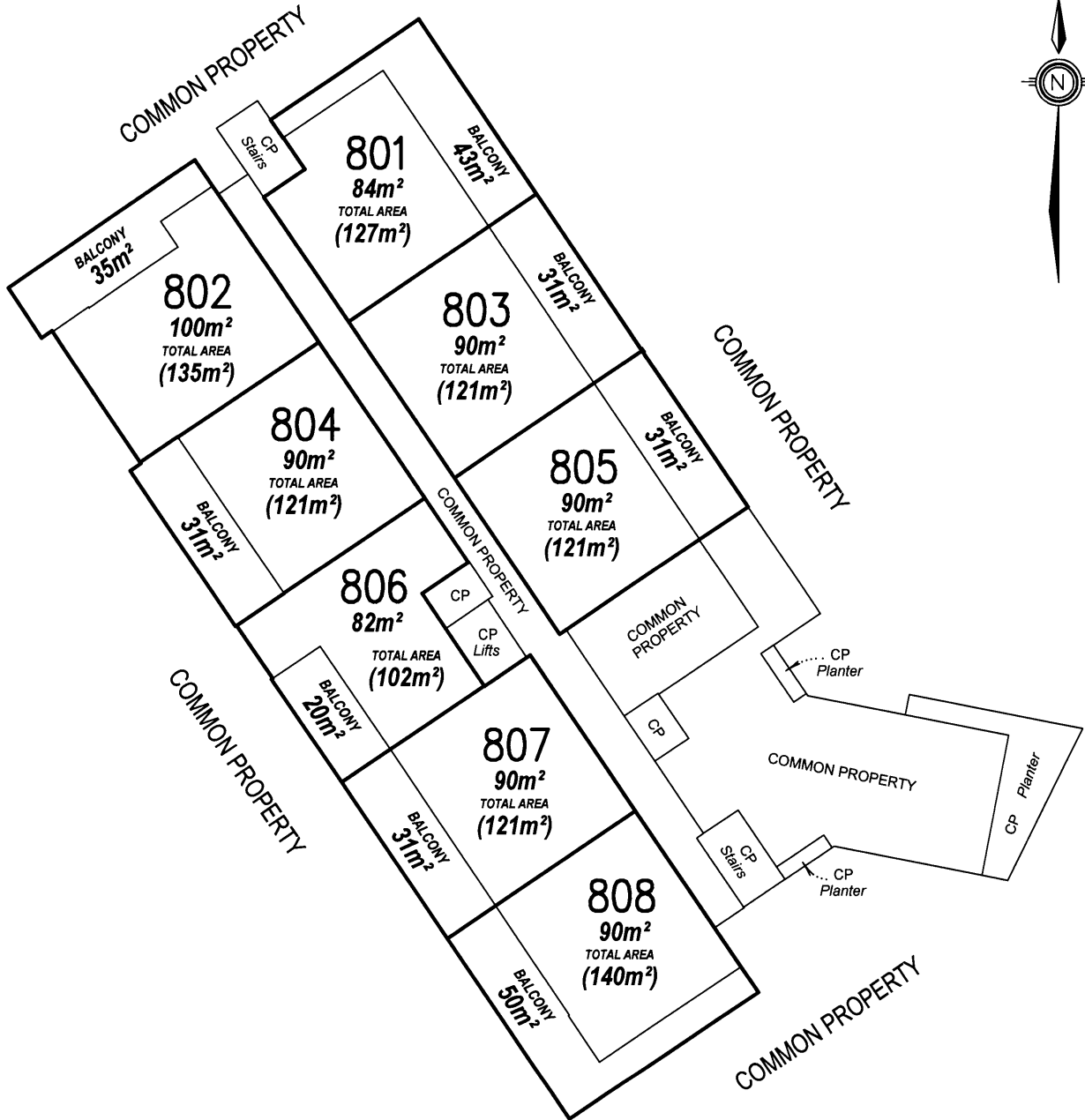

Scale 1:250 - Lengths are in Metres.

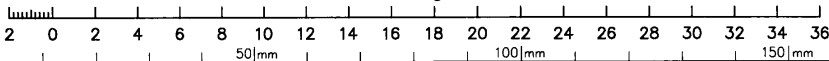

State copyright reserved.

Insert Plan Number SP290655