

Land Title Act 1994; Land Act 1994
Form 21 Version 2

SURVEY PLAN

Sheet 1 of 5

REFERENCE MARKS

STN	TO	ORIGIN	BEARING	DIST
1	O.Nail	29/SP161696	271°37'	28.728
1	O.Nail	1/SP170434	310°36'	14.837
5	O.Nail in Podium Slab	26/SP161696	215°10'	50.96

PERMANENT MARKS

PM	ORIGIN	BEARING	DIST	NO
1-OPM	34/SP161696	306°46'10"	113.026	155749
6-OPM	6/SP170432	3°12'20"	44.693	160780

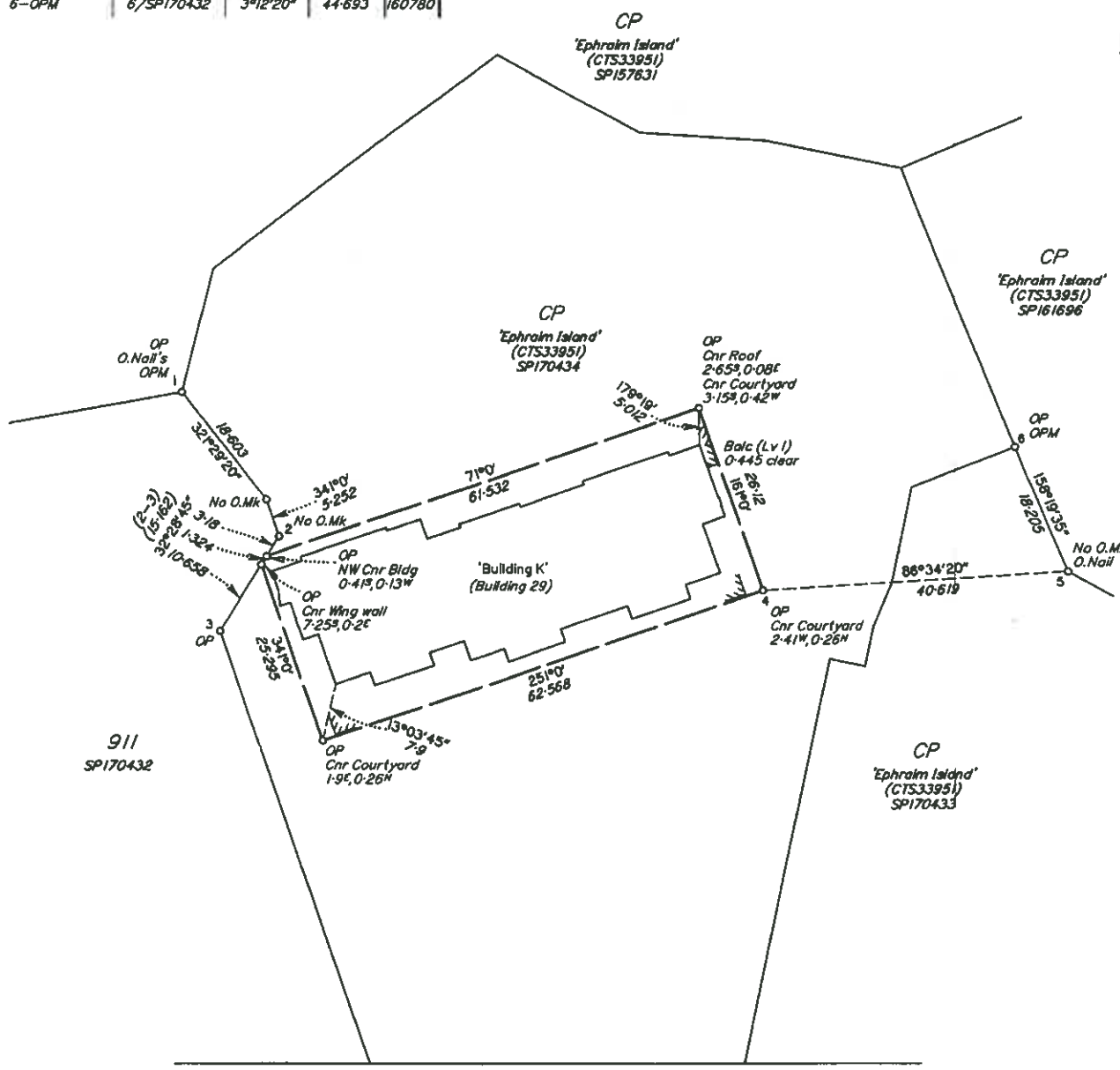

911
SP170432

2
USL33907

Area of Base Parcel
1634 m²

SCALE 1:600



B.B.H. PTY. LTD. (ACN 010 427 531) hereby certify that the land comprised in this plan was surveyed by the corporation, by Stephen William Mavor, Cadastral Surveyor, for whose work the corporation accepts responsibility, and that the plan is accurate, that the said survey was performed in accordance with the Survey and Mapping Infrastructure Act 2003 and Surveyors Act 2003 and associated Regulations and Standards and that the said survey was completed on 24/01/2006.



Director
Director
Date: 11/10/2006

Plan of Lots 29101-29106, 29201-29206, 29301-29306, 29401-29406, 29501-29506, 29601-29605, 29701, 29702, 29801, 29802 and Common Property

Cancelling Lot 106 on SP170434
PARISH: **BARROW**
Meridion: SP170434

COUNTY: **Ward**

F/N'a: No

Scale: **1:600**

Format: **BUILDING**



Plan Status

BENNETT & BENNETT 02 067 4306 (22006787PW_D.DWG) DC Rev-D 2/10/06

710292431

WARNING : Folded or Mutilated Plans will not be accepted. Plans may be rolled. Information may not be placed in the outer margins.

\$2801.50
29/01/2007 16:05

BE 400 NT

Registered

s. Lodged by

ClarkeKann 122

(Include address, phone number, reference, and Lodger Code)

1. Certificate of Registered Owners or Lessees.

MIRVAC QUEENSLAND PTY LIMITED
ACN 060 411 207
LEWIAC LAND PTY LIMITED
ACN 009 793 337

(Names in full)

*as Registered Owners of this land agree to this plan and dedicate the Public Use Land as shown hereon in accordance with Section 50 of the Land Title Act 1994.

*as Lessees of this land agree to this plan.

Signature of *Registered Owners *Lessees
SIGNED SEALED AND DELIVERED ON BEHALF OF
MIRVAC QUEENSLAND PTY LIMITED ACN 060 411 207
BY ITS ATTORNEYS MICHAEL JOHN LYNCH AND
PETER RAYMOND GIBBS UNDER POWER OF
ATTORNEY NO. 707400207

MICHAEL JOHN LYNCH

PETER RAYMOND GIBBS

WITNESS:
SIGNED SEALED AND DELIVERED ON BEHALF OF
LEWIAC LAND PTY LIMITED ACN 009 793 337 BY ITS
ATTORNEYS MICHAEL JOHN LYNCH AND PETER
RAYMOND GIBBS UNDER POWER OF ATTORNEY
NO. 708 225 241

MICHAEL JOHN LYNCH

PETER RAYMOND GIBBS

WITNESS:
* Rule out whichever is inapplicable

2. Local Government Approval.

COUNCIL OF THE CITY OF GOLD COAST

hereby approves this plan in accordance with the :

% INTEGRATED PLANNING ACT 1997

Dated this 17th day of January 2007

David Andrew Lohor
Authorising Officer

* Insert the name of the Local Government. % Insert Integrated Planning Act 1997 or
Insert designation of signatory or delegation Local Government (Planning & Environment) Act 1990

3. Plans with Community Management Statement :

CMS Number :
Name : EPHRAIM ISLAND SUBSIDIARY 106

4. References :

Dept File :
Local Govt :
Surveyor : 02.067.A30A

6. Existing			Created		
Title Reference	Lot	Plan	Lots	Emts	Road
50634244	106	SPI70434	29101-29106, 29201-29206, 29301-29306, 29401-29406, 29501-29506, 29601-29605, 29701, 29702, 29801, 29802 & CP		

29101-29106,
29201-29206,
29301-29306,
29401-29406,
29501-29506,
29601-29605,
29701, 29702,
29801, 29802
& CP

Lot 112 on WD6564

Lots	Orig

7. Portion Allocation :

8. Map Reference :
9542-2241

9. Locality :
PARADISE POINT

10. Local Government :
GOLD COAST CITY COUNCIL

11. Passed & Endorsed :
By: B.B.H. PTY. LTD. ACN 010 427 531
Date: 20.12.2006
Signed:
Designation: Cadastral Surveyor

Date of Development Approval: 7/9/2004

12. Building Format Plans only.

I certify that:
* As far as it is practical to determine, no part of the building shown on this plan encroaches onto adjoining lots or road;
~~* Part of the building shown on this plan encroaches onto adjoining lots and road.~~

Cadastral Surveyor/Director * Date 11.10.2006
*delete words not required

13. Lodgement Fees :

Survey Deposit \$
Lodgement \$
New Titles \$
Photocopy \$
Postage \$
TOTAL \$

14. Insert Plan Number
SP170436

LEVEL A

(Basement)
Scale 1:300

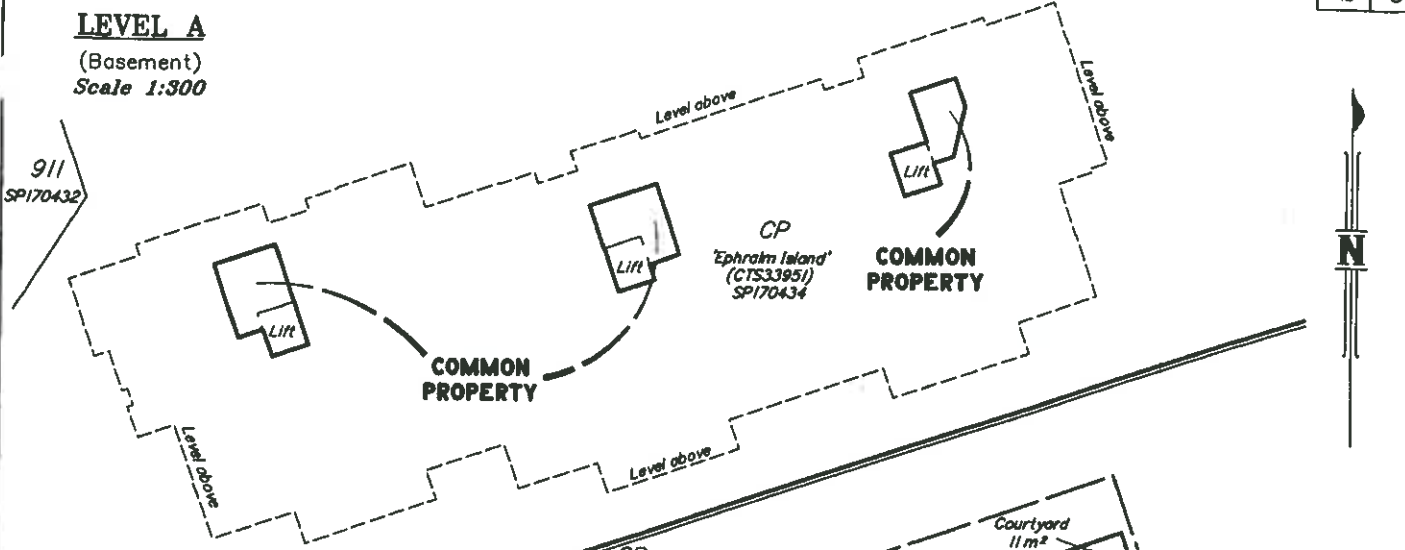

LEVEL B

(Level 1)
Scale 1:300

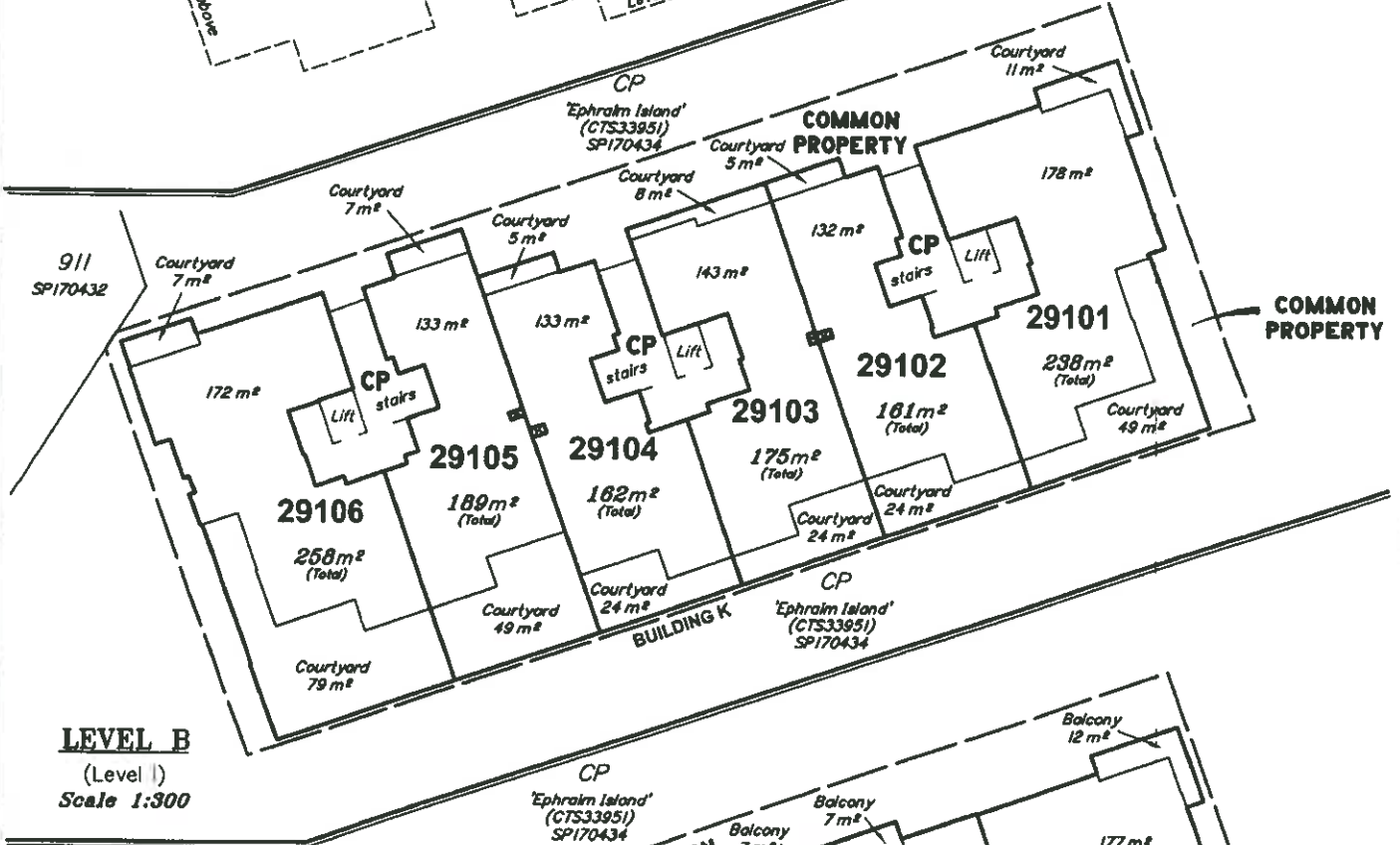

LEVEL C

(Level 2)
Scale 1:300

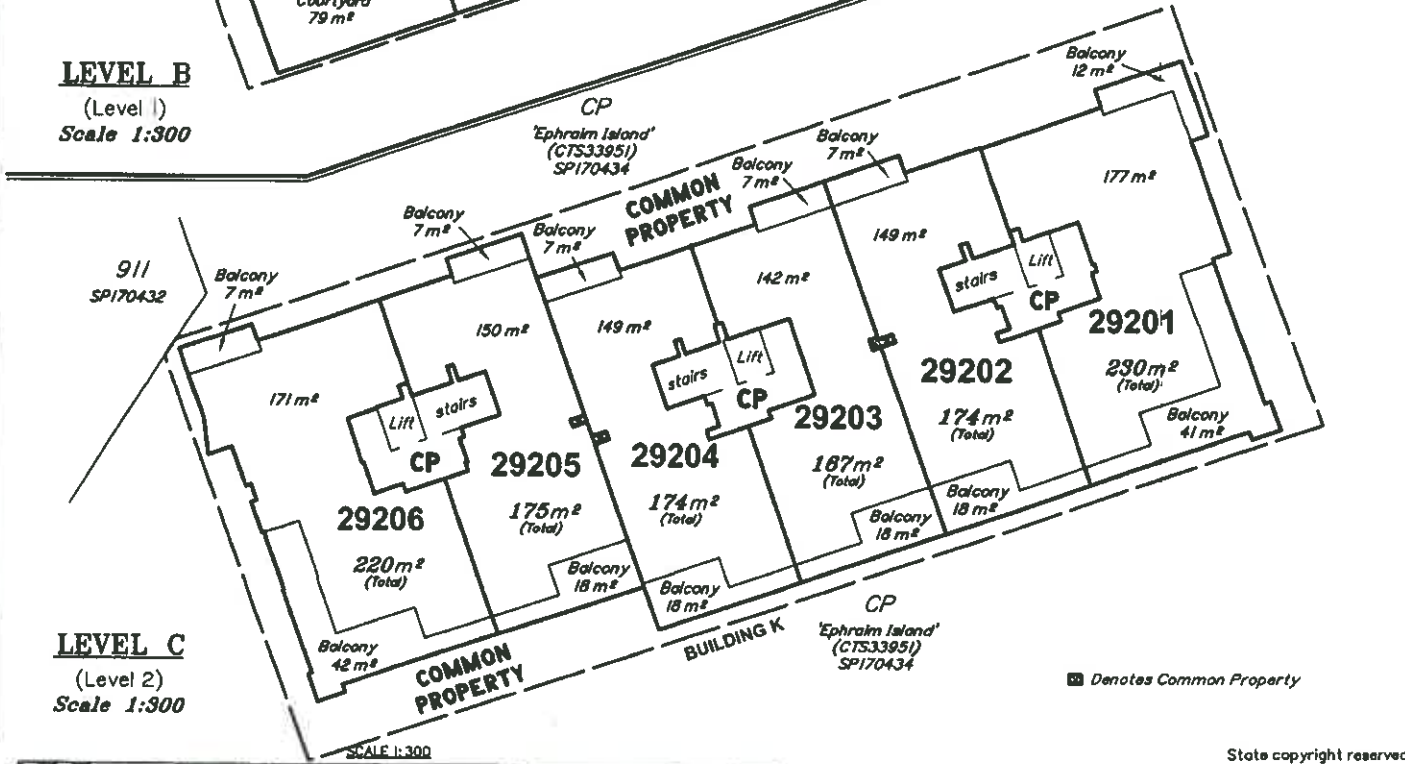

■ Denotes Common Property



State copyright reserved.

Insert Plan Number **SP170436**

LEVEL D

(Level 3)

Scale 1:300

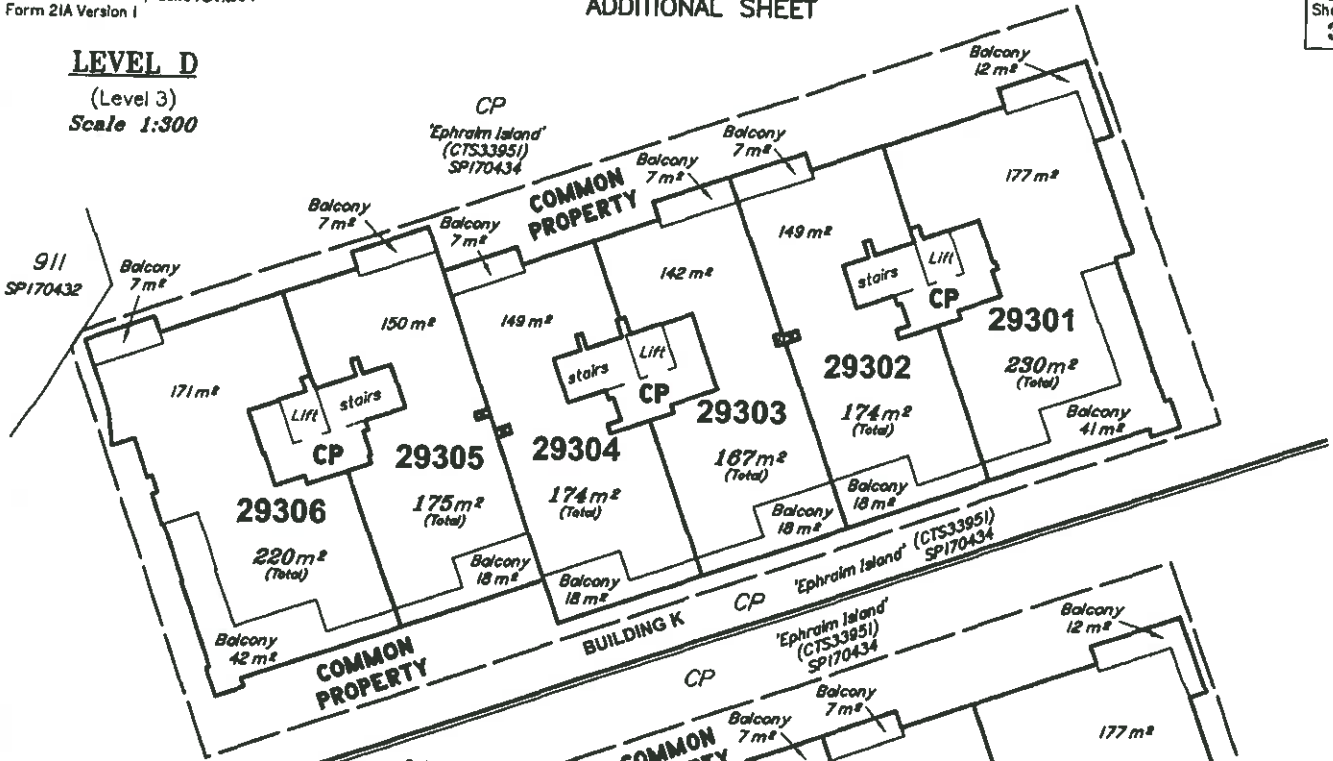

LEVEL E

(Level 4)

Scale 1:300

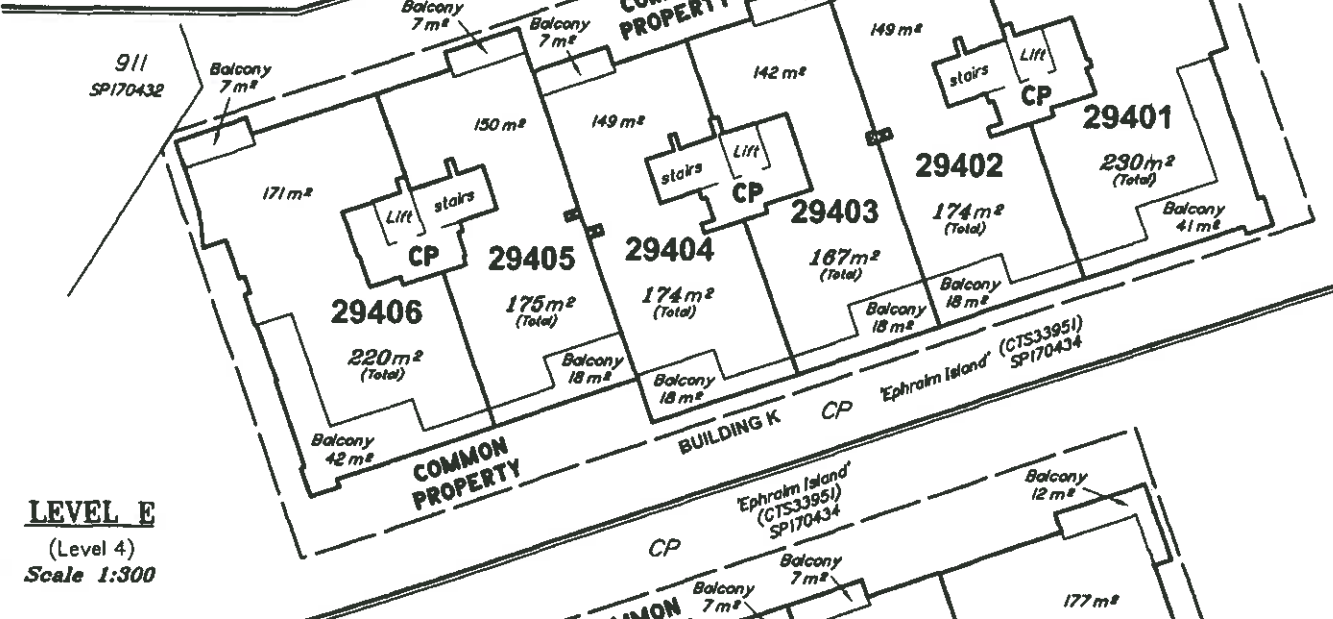

LEVEL F

(Level 5)

Scale 1:300

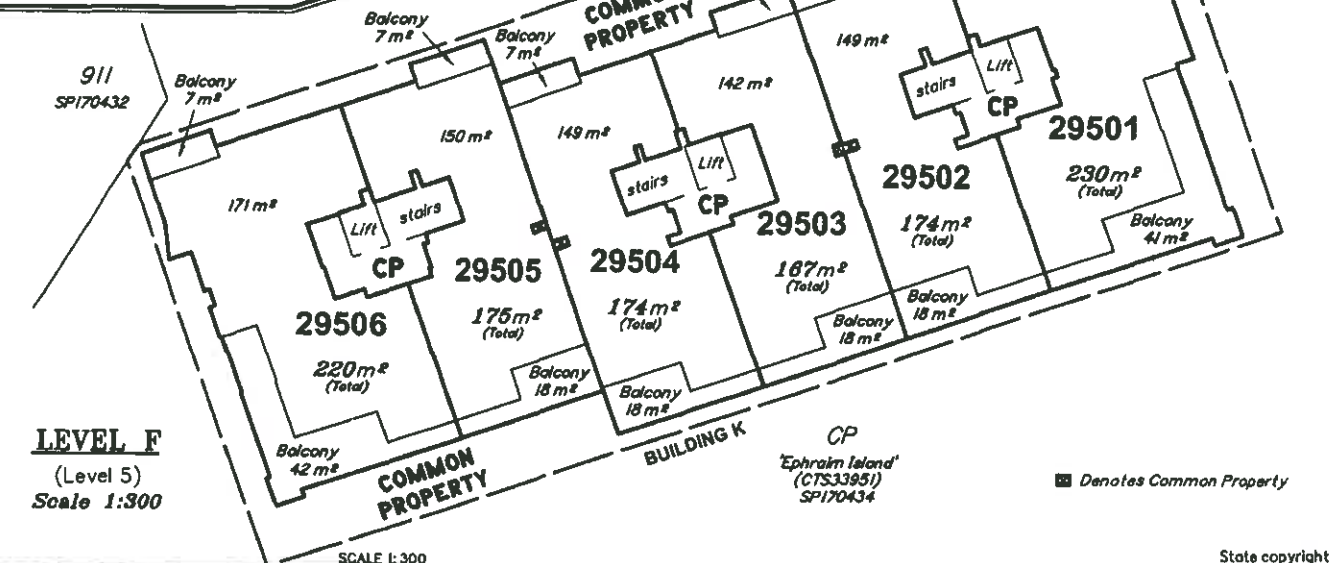

SCALE 1:300

State copyright reserved.



Inset Plan Number **SP170436**

LEVEL G

(Level 6)
Scale 1:300

911
SP170432

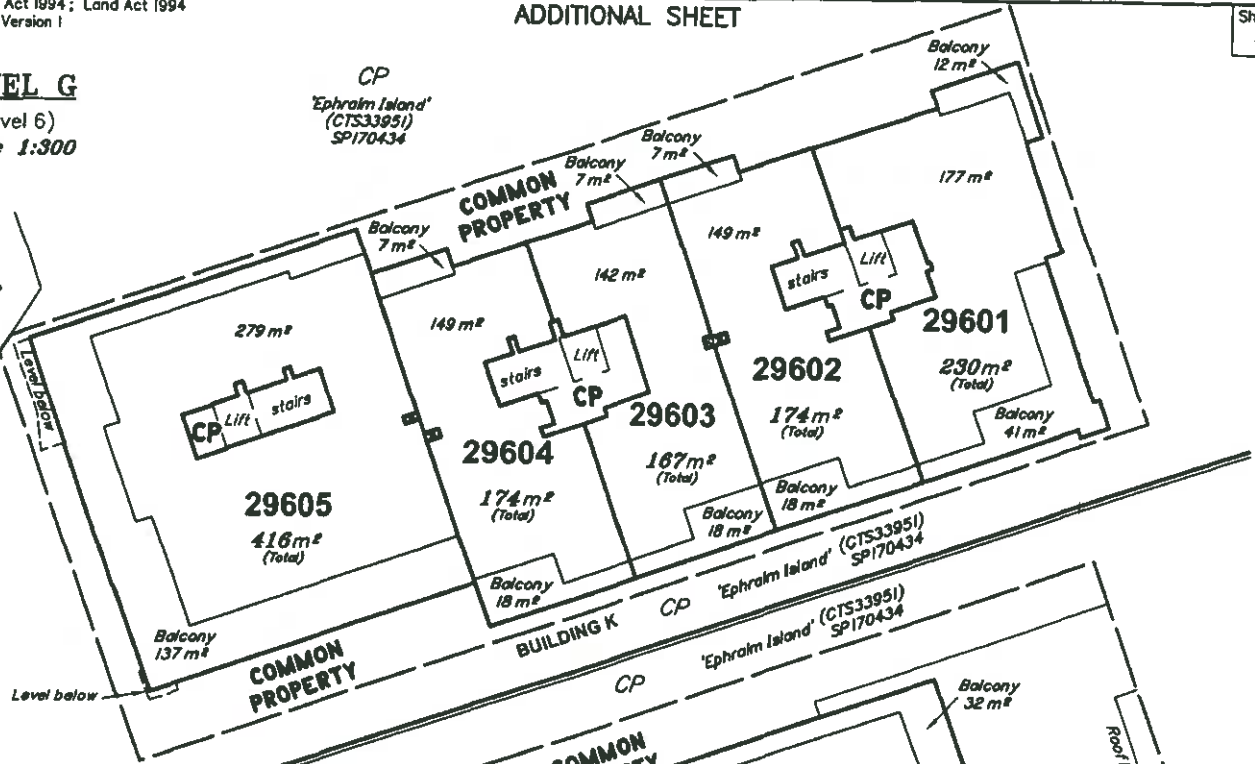

911
SP170432

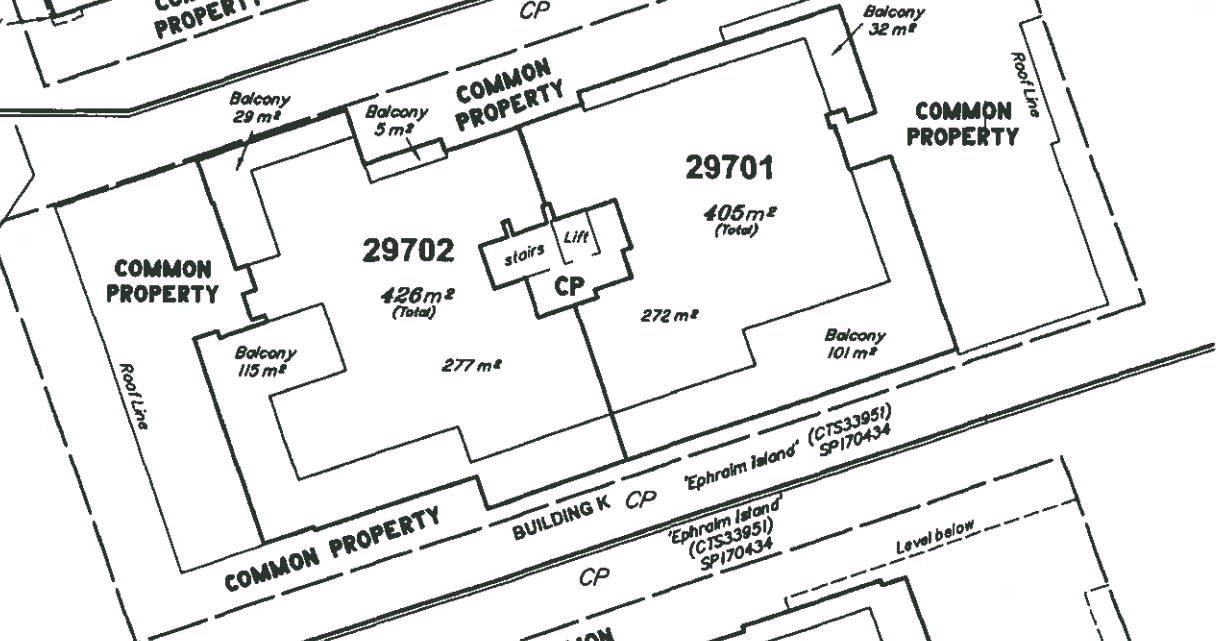

LEVEL H

(Level 7)
Scale 1:300

911
SP170432

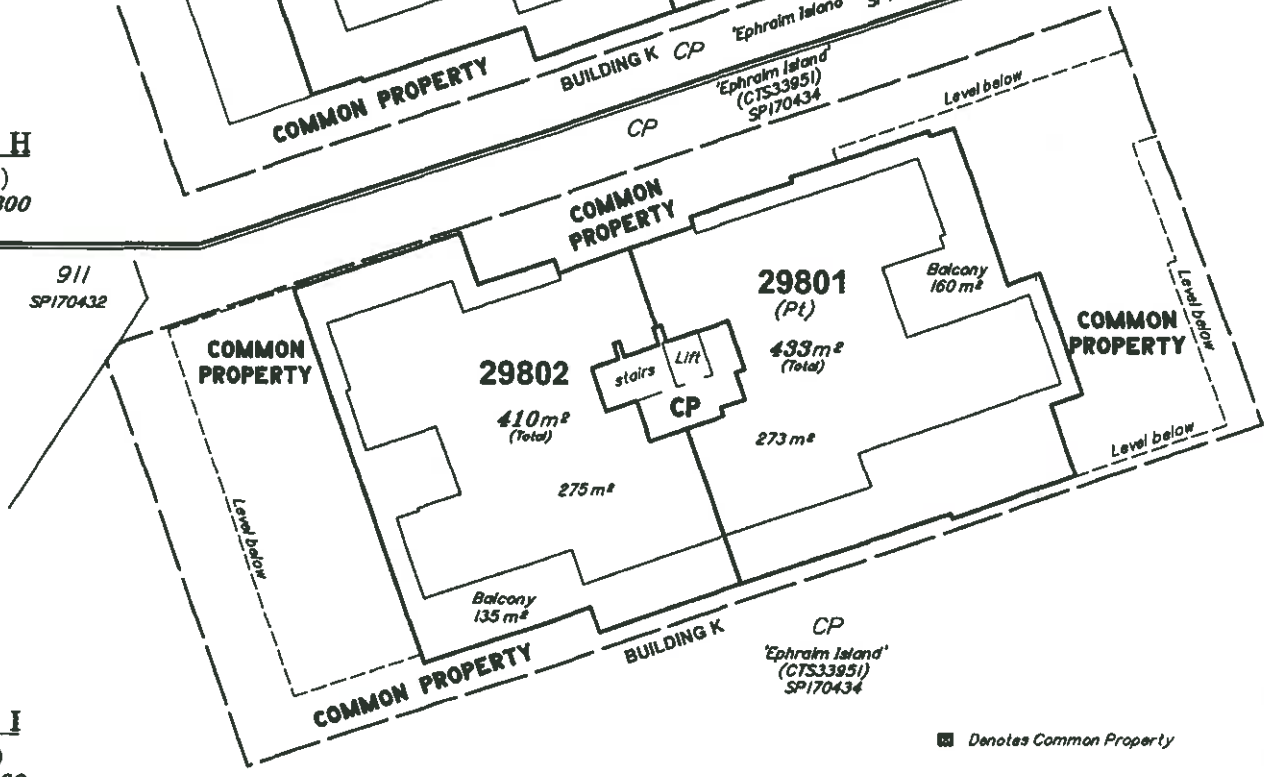

LEVEL I

(Level 8)
Scale 1:300

■ Denotes Common Property

SCALE 1:300



State copyright reserved.

Insert Plan Number **SP170436**

LEVEL J

(Roof Level)

Scale 1:300

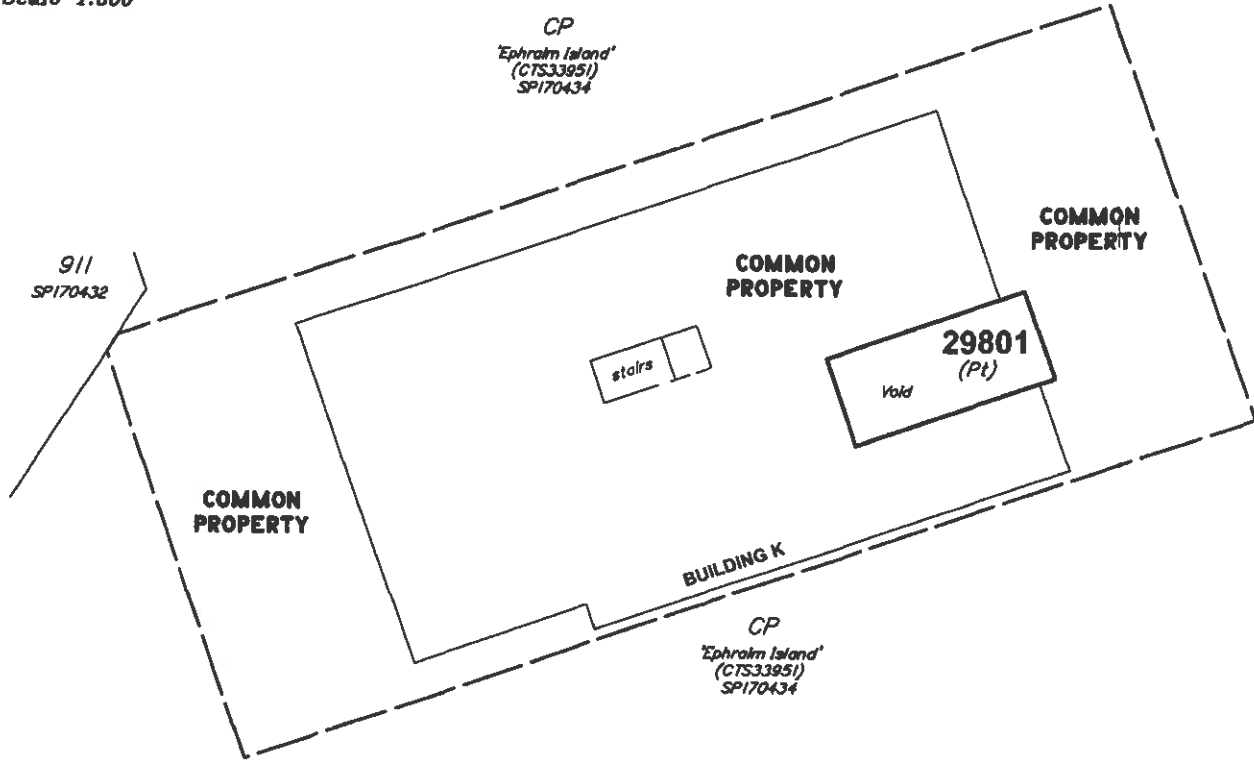

LATERAL ASPECT

Not to Scale
(Looking North)

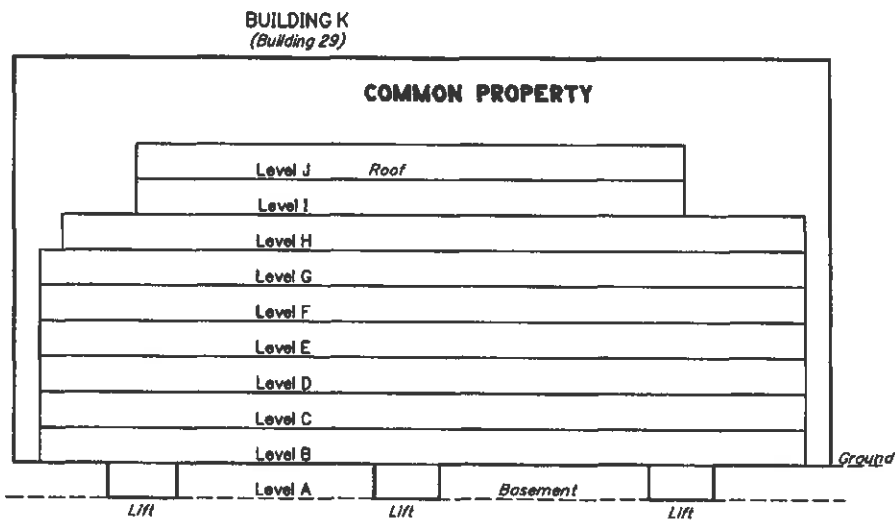

CP
'Ephraim Island'
(CTS3395)
SP170434

State copyright reserved.

Insert Plan Number **SP170436**



Land Title Act 1994, Land Act 1994
Form 21 Version 2

SURVEY PLAN

Sheet 1 of 5

PERMANENT MARKS

PM	ORIGIN	BEARING	DIST	NO
1 OPM	34/SP161696	348°49'15"	68.44	155749
3-OPM	3/SP199716	72°03'40"	120.45	160780

REFERENCE MARKS

STN	TO	ORIGIN	BEARING	DIST
1	O.Ram Nail	29/SP161696	57°02'20"	28.41
1	OIP	29/SP161696	88°00'40"	36.317
1	O.Ram Nail in Conc Path	29/SP161696	89°39'	48.552
2	O.Ram Nail	2/SP199716	146°13'35"	24.392

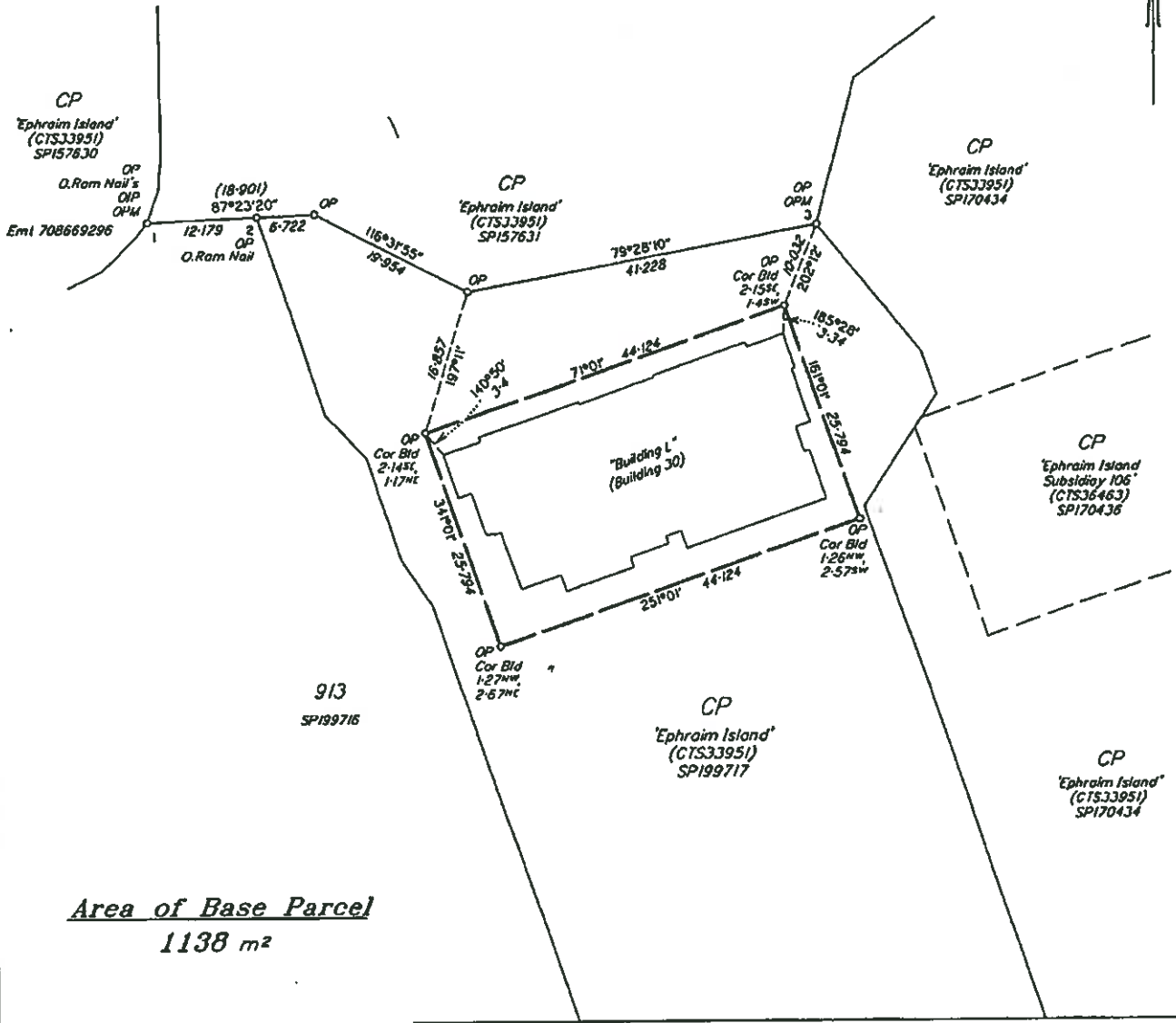

Area of Base Parcel
1138 m²

2

USL33907

SCALE 1:500



B.B.H. PTY. LTD. (ACN 010 427 531) hereby certify that the land comprised in this plan was surveyed by the corporation, by Craig John Purdon, Surveying Associates for whose work the corporation accepts responsibility, under the supervision of Stephen William Mevor, Cadastral Surveyor, and that the plan is accurate, that the said survey was performed in accordance with the Survey and Mapping Infrastructure Act 2003 and Surveyors Act 2003 and associated Regulations and Standards and that the said survey was completed on 17/007.



Director
Date 20.11.07

Plan of Lots 30101-30104, 30201-30204, 30301-30304, 30401-30404, 30501-30504, 30601-30603, 30701, 30702, 30801 & Common Property

Canceling Lot 106 on SPI99717

PARISH: **BARROW** COUNTY: **Ward**

Mention: SPI99716

F/N's: No

Scale: 1:500

Format: **BUILDING**



SP199719

Plan Status:

BCHNETT & BUCHHEIT 02.06.07 (2006/28/P7_C.DWG) MCH Rev.C 29/11/07

711504251

\$2009.70
14/03/2008 11:11

BE 400 NT

WARNING : Folded or Mutilated Plans will not be accepted,
Plans may be rolled.
Information may not be placed in the outer margins.

Registered

Lodged by

(Include address, phone number, reference, and Ledger Code)

1. Certificate of Registered Owners or Lessees.

1/We MIRVAC QUEENSLAND PTY LIMITED
ACN 060 411 207
LEWIAC LAND PTY LIMITED
ACN 009 793 337.

(Names in full)

* as Registered Owners of this land agree to this plan and dedicate the Public Use Land as shown hereon in accordance with Section 50 of the Land Title Act 1994.

* as Lessees of this land agree to this plan.

Signature of Registered Owners Lessees
I, JAMES WALLACE AND GERALD ANDREW VANDERMEYDE ON BEHALF
OF MIRVAC QUEENSLAND PTY LIMITED ACN
060 411 207 BY ITS ATTORNEY MATTHEW JAMES WALLACE
WALLACE AND GERALD ANDREW VANDERMEYDE UNDER
POWER OF ATTORNEY NO. 711081257

MATTHEW JAMES WALLACE
GERALD ANDREW VANDERMEYDE

WITNESSES:
I, JAMES WALLACE AND GERALD ANDREW VANDERMEYDE ON BEHALF
OF LEWIAC LAND PTY LIMITED ACN 009 793 337 BY
ITS ATTORNEYS MATTHEW JAMES WALLACE
AND GERALD ANDREW VANDERMEYDE UNDER
POWER OF ATTORNEY NO. 711267512

MATTHEW JAMES WALLACE
GERALD ANDREW VANDERMEYDE

WITNESSES:
* Rule out whichever is inapplicable

2. Local Government Approval.

* COUNCIL OF THE CITY OF GOLD COAST

hereby approves this plan in accordance with the:

* INTEGRATED PLANNING ACT 1997

Dated this 29th day of February 2008

David Andrew Lohar
Authorising Officer

* Insert the name of the Local Government, or of signature or delegation of the Local Government (Planning & Environment) Act 1990. * Insert Integrated Planning Act 1997 or Local Government (Planning & Environment) Act 1990

3. Plans with Community Management Statement:

CMS Number: 36463
Name: EPHRAIM ISLAND SUBSIDIARY 108

4. References:

Dept File:
Local Govt: N/293639 106/02
Surveyor: 02.067.A30A

5. Existing

Title Reference Lot Plan
50300439 106 SP199717

(To issue)

Created

Lots Ems Road
30101-30104,
30201-30204,
30301-30304,
30401-30404,
30501-30504,
30601-30603,
30701, 30702,
30801 & CP

30101-30104,
30201-30204,
-30304,
-30404,
-30504,
-30603,
30702,
1 & CP
on W08564

Date of Development Approval: 7/9/2004

12. Building Format Plans only.

I certify that:
* As far as it is practical to determine, no part of the building shown on this plan encroaches onto adjoining lots or road;
~~* Part of the building shown on this plan encroaches onto adjoining lots and road.~~

Cadastrial Surveyor/Director Date 30-11-07
* date words not required

Lots Orig

7. Portion Allocation:

8. Map Reference:
9542-22441

9. Locality:
PARADISE POINT

10. Local Government:
GOLD COAST CITY COUNCIL

11. Passed & Endorsed:
By: B.B.H. PTY. LTD. ACN 010 427 531
Date: 13.2.08
Signed: 
Designation: Cadastrial Surveyor

13. Lodgement Fees:

Survey Deposit \$
Lodgement \$
... New Titles \$
Photocopy \$
Postage \$
TOTAL \$

14. Insert Plan Number
SP199719

LEVEL A

(Basement Level)
Scale 1:300

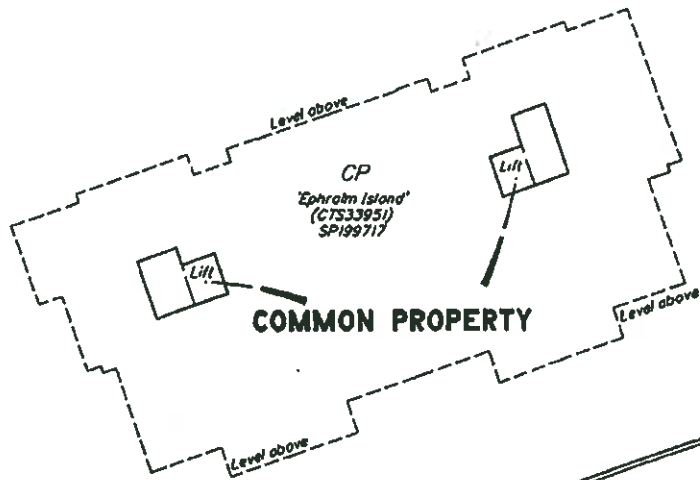

LEVEL B

(Level 1)
Scale 1:300

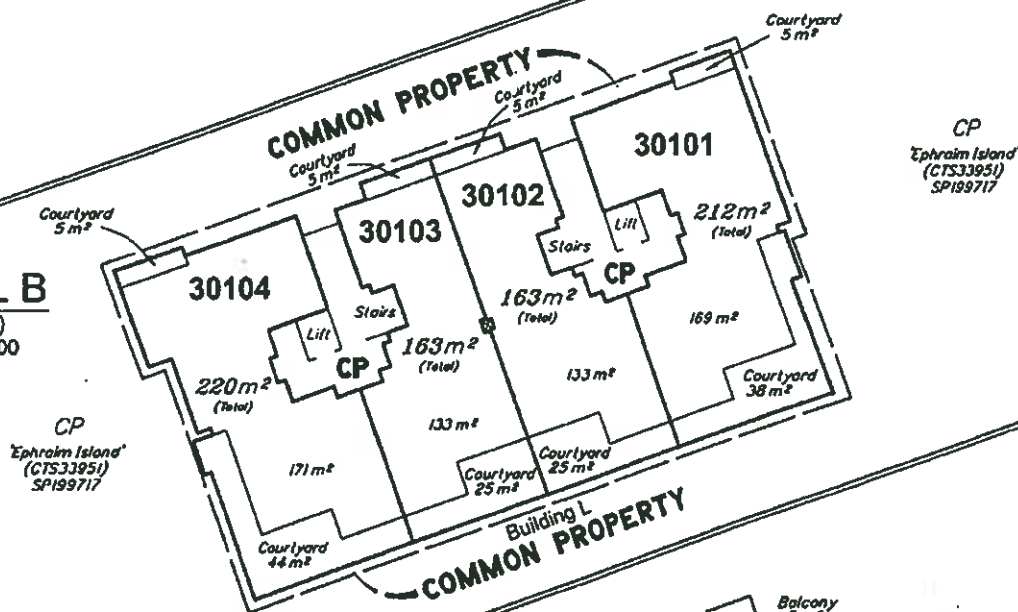

LEVEL C

(Level 2)
Scale 1:300

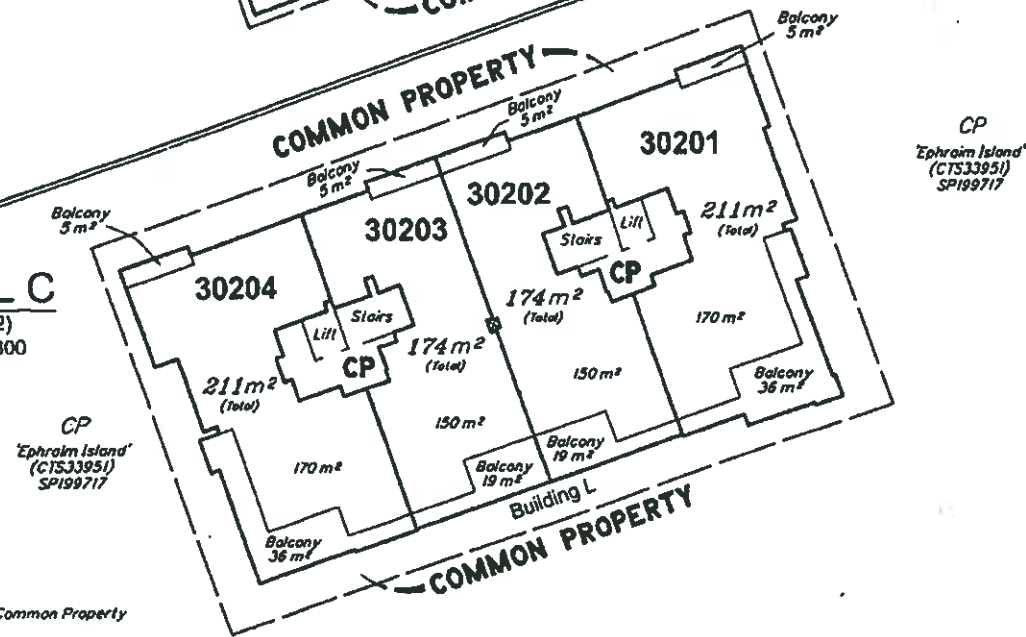

☒ denotes Common Property

SCALE 1:300



State copyright reserved.

Insert Plan Number **SP199719**

BENNETT & BENNETT 02-067 (020678P7_C.DWG) MCH Rev.C 29/11/07

LEVEL D

(Level 3)
Scale 1:300

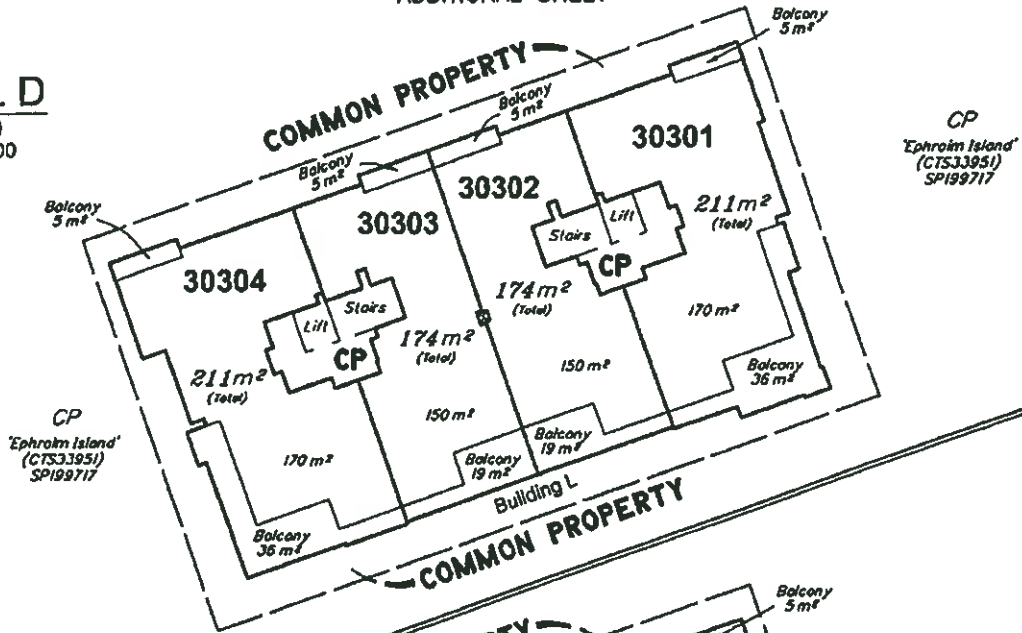

LEVEL E

(Level 4)
Scale 1:300

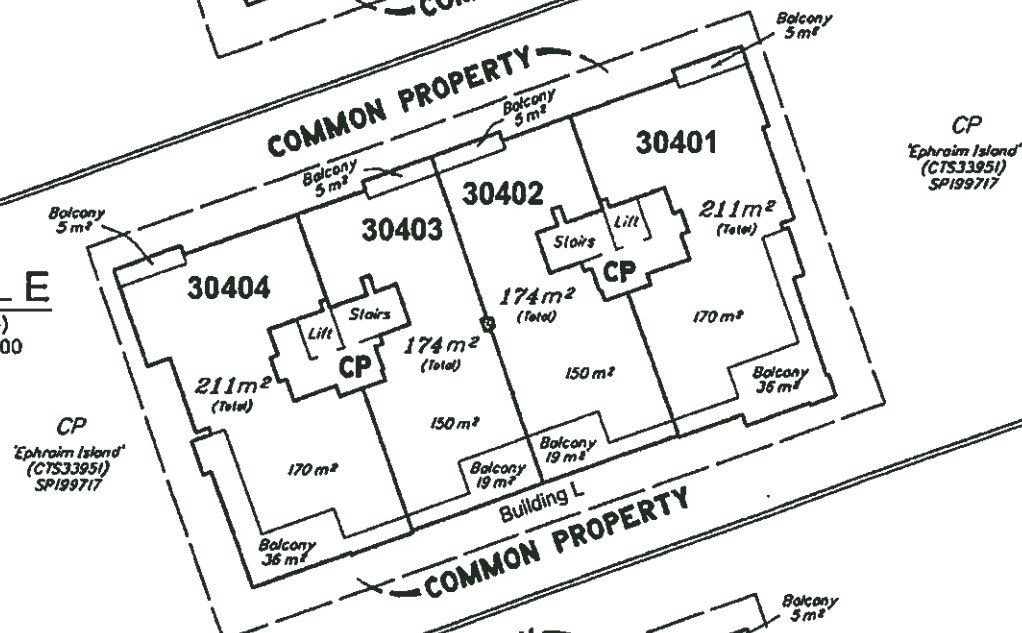

LEVEL F

(Level 5)
Scale 1:300

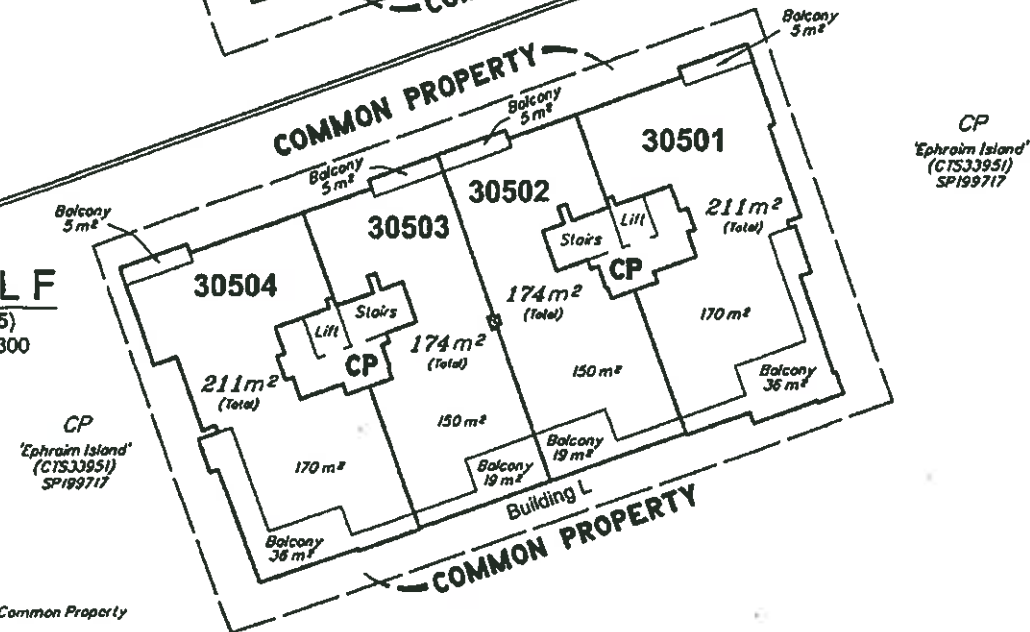

☒ denotes Common Property

SCALE 1:300



State copyright reserved.

Insert Plan Number **SP199719**

BENNETT & BENNETT 02-067 (02067887)_CD.MXD MCM Rev. C 29/11/07

LEVEL G

(Level 6)
Scale 1:300

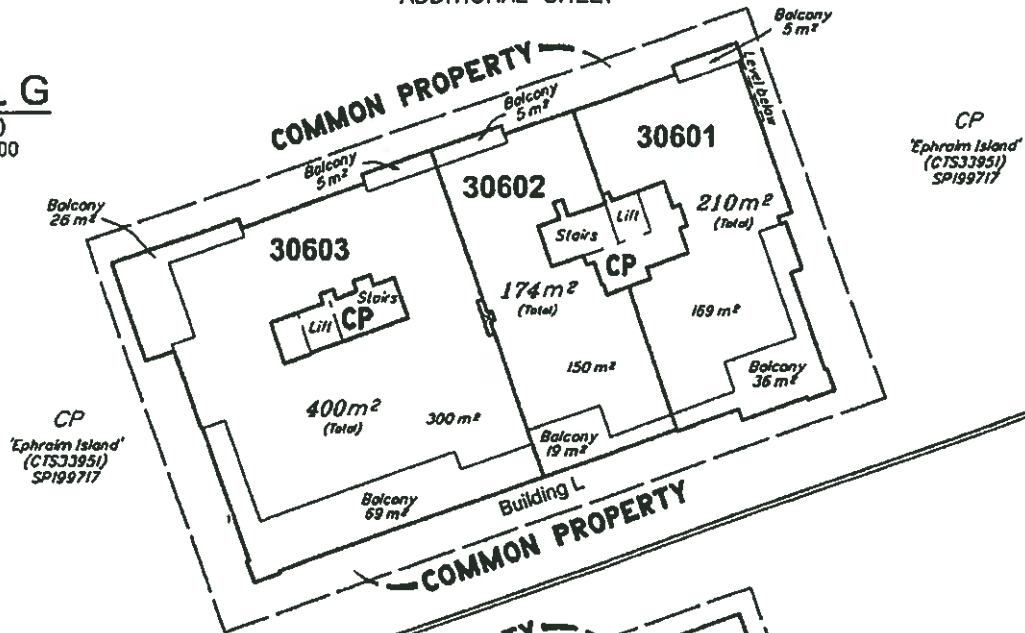

LEVEL H

(Level 7)
Scale 1:300

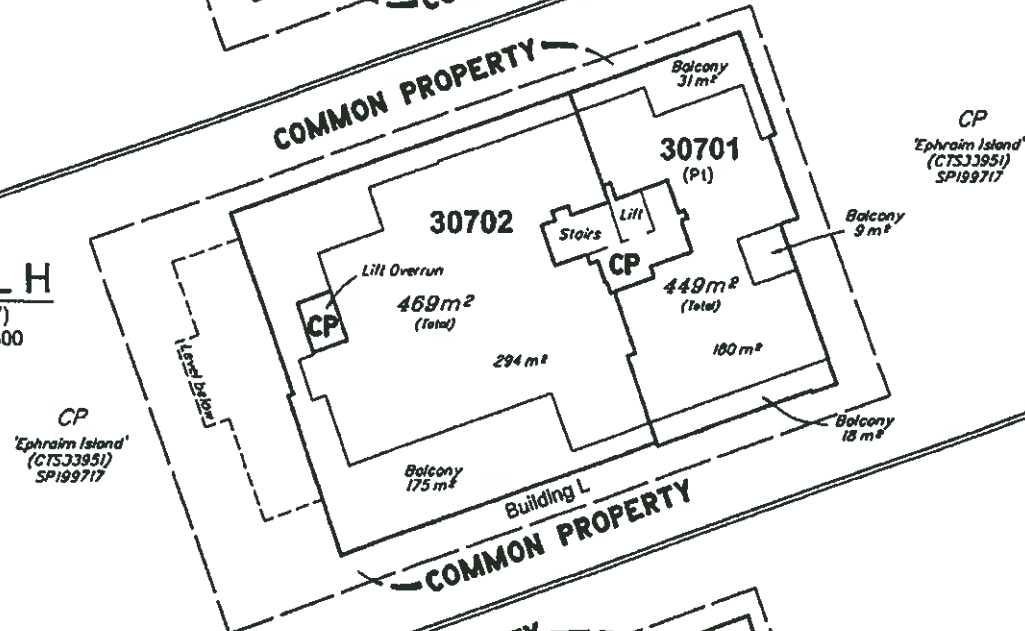

LEVEL I

(Level 8)
Scale 1:300

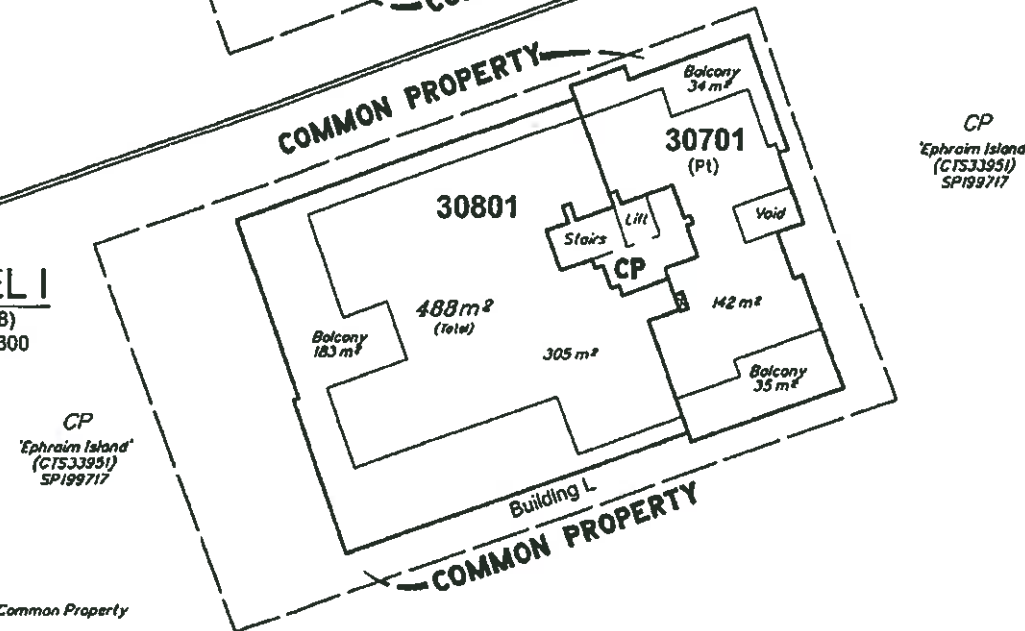

☒ denotes Common Property

SCALE 1:300



State copyright reserved.

Insert Plan Number **SP199719**

LEVEL J

(Roof Level)
Scale 1:300

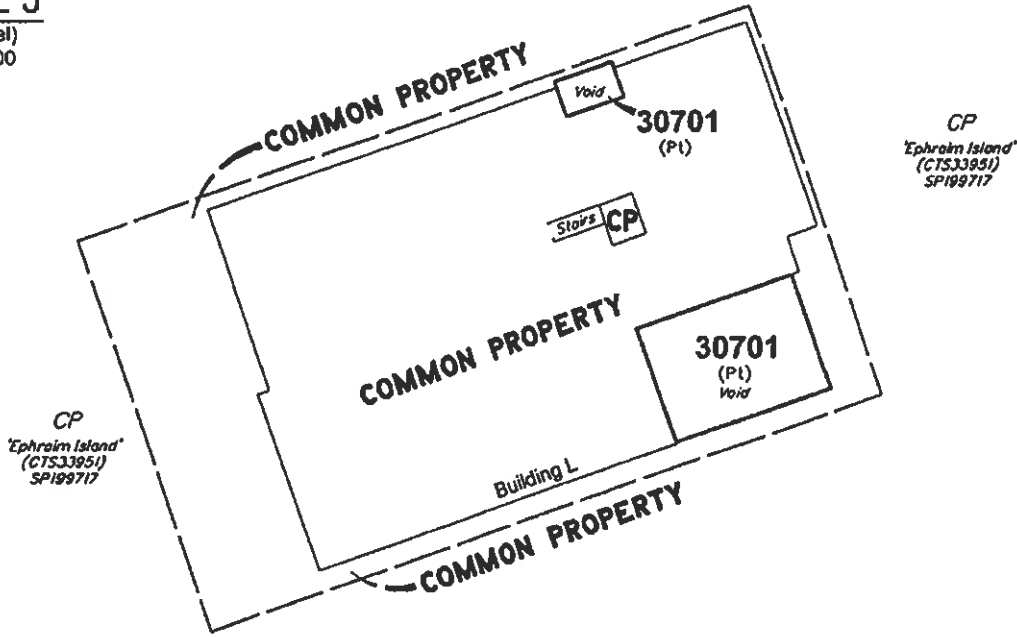

LATERAL ASPECT VIEW

(Looking Northwest)
(Not to scale)

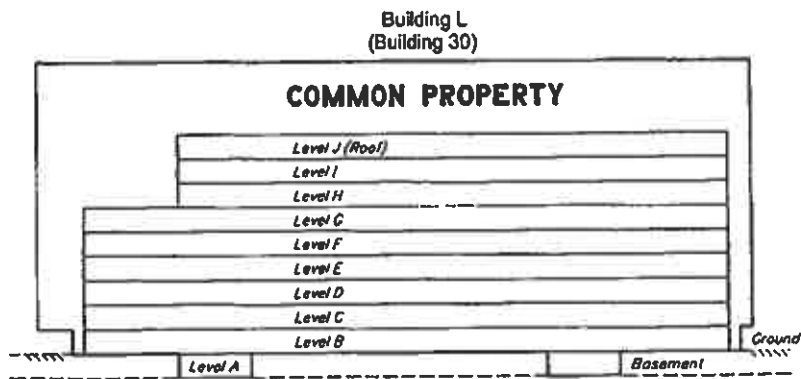

CP
Ephraim Island
(CTS33851)
SP199717

☐ denotes Common Property

SCALE 1:300

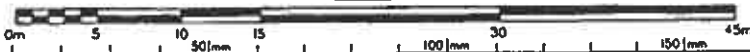

State copyright reserved.

Insert Plan Number **SP199719**

BECKETT & BENNETT 02.007 (020078PPT...C.DWG) MCH Rev: C 29/11/01

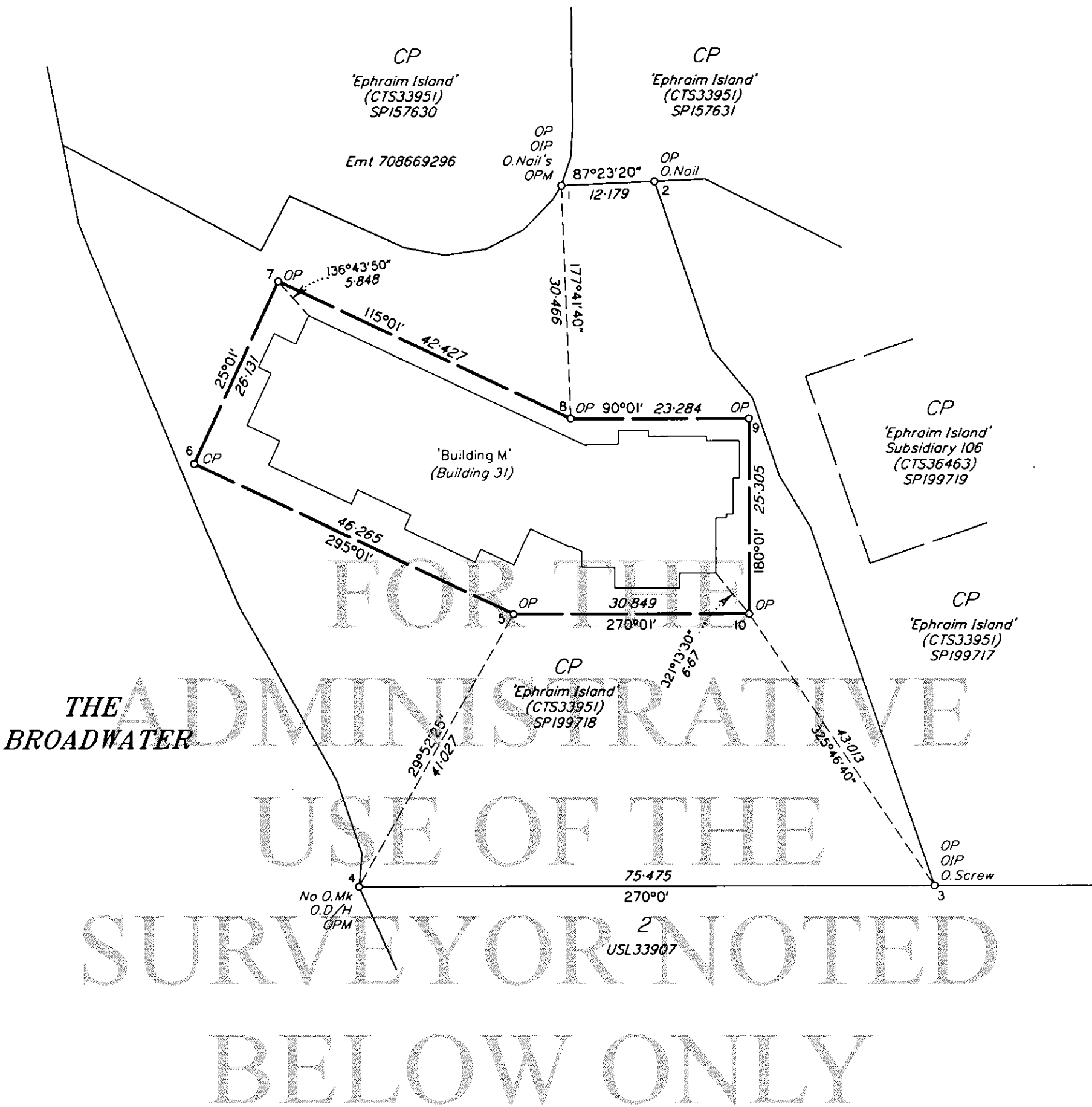

THE BROADWATER

REFERENCE MARKS

STN	TO	ORIGIN	BEARING	DIST
1	O.Ram Nail	29/SP161696	57°02'20"	28.41
1	OIP	29/SP161696	88°00'40"	36.317
1	O.Ram Nail in Conc Path	29/SP161696	89°39'	48.552
2	O.Nail in Kerb	2/SP199716	146°13'35"	24.392
3	OIP	10/SP199716	36°25'10"	19.803
3	O Screw in Rev. Wall	10/SP199716	3°19'40"	20.192
4	O.D/H	5/SP170432	31°0'	3.372

PERMANENT MARKS

PM	ORIGIN	BEARING	DIST	NO
1-OPM	34/SP161696	348°49'15"	68.44	155749
4-OPM	10/SP146781	340°50'	40.253	118031

Area of Base Parcel
1844 m²

SCALE 1:600



0 50mm 100mm 150mm State copyright reserved

B.B.H. PTY. LTD. (ACN 010 427 531) hereby certify that the land comprised in this plan was surveyed by the corporation, by Craig John Purdon, Surveying Associate for whose work the corporation accepts responsibility, under the supervision of Stephen William Mavor, Cadastral Surveyor, and that the plan is accurate, that the said survey was performed in accordance with the Survey and Mapping Infrastructure Act 2003 and Surveyors Act 2003 and associated Regulations and Standards and that the said survey was completed on 09/2/2008



Director
Director
Date: 6-2-08

Plan of Lots 31101-31106, 31201-31206, 31301-31306, 31401-31406, 31501-31506, 31601, 31602, 31701, 31702, 31801 & Common Property

Cancelling Lot 106 on SP199718

PARISH: **BARROW** COUNTY: **Ward**

Meridian: SP199716

F/N's: No

Scale: 1:600
Format: BUILDING



Plan Status:

BENNETT & BENNETT 02.067 (020678)P8_B.DWC) MCH Rev.B 30/1/08

**WARNING : Folded or Mutilated Plans will not be accepted.
Plans may be rolled.
Information may not be placed in the outer margins.**

711504331

\$2622.60
14/03/2008 11:17

BE 400 NT

Registered

5 Lodged by

(Include address, phone number, reference, and Lodger Code)

1. Certificate of Registered Owners or Lessees.

+/We **MIRVAC QUEENSLAND PTY LIMITED**
ACN 060 411 207
LEWIAC LAND PTY LIMITED
ACN 009 793 337

(Names in full)

* as Registered Owners of this land agree to this plan and dedicate the Public Use Land as shown hereon in accordance with Section 50 of the Land Title Act 1994.

* as Lessees of this land agree to this plan.

Signature of *Registered Owners *Lessees

SIGNED SEALED AND DELIVERED ON BEHALF OF
MIRVAC QUEENSLAND PTY LIMITED ACN 060 411 207
BY ITS ATTORNEYS MATTHEW JAMES WALLACE
AND GERALD ANDREW VANDERMEYDE UNDER
POWER OF ATTORNEY NO. 710814357

MATTHEW JAMES WALLACE GERALD ANDREW VANDERMEYDE

WITNESS:
SIGNED SEALED AND DELIVERED ON BEHALF OF
LEWIAC LAND PTY LTD ACN 009 793 337 BY
IT ATTORNEYS MATTHEW JAMES WALLACE
AND GERALD ANDREW VANDERMEYDE
UNDER POWER OF ATTORNEY NO. 711267512

MATTHEW JAMES WALLACE GERALD ANDREW VANDERMEYDE

* Rule out whichever is inapplicable

2. Local Government Approval.

* **COUNCIL OF THE CITY OF GOLD COAST**

hereby approves this plan in accordance with the:

% **INTEGRATED PLANNING ACT 1997**

Dated this

7th day of March 2008

David Andrew Lohoar
Authorising Officer

#

* Insert the name of the Local Government. % Insert Integrated Planning Act 1997 or
Insert designation of signatory or delegation Local Government (Planning & Environment) Act 1990

3. Plans with Community Management Statement :

CMS Number : 36463
Name : EPHRAIM ISLAND SUBSIDIARY I06

4. References :

Dept File :
Local Govt :
Surveyor : 02.067.A30A

6. Existing

Title Reference	Lot	Plan
50700A39	106	SP199718
↓ (TO ISSUE)		

Created

Lots	Emts	Road
31101-31106, 31201-31206, 31301-31306, 31401-31406, 31501-31506, 31601, 31602, 31701, 31702, 31801 & CP		

31101-31106, 31201-31206, 31301-31306, 31401-31406, 31501-31506, 31601, 31602, 31701, 31702, 31801 & CP	Lot 112 on WD6564
Lots	Orig

Development Approval: 7/9/2004

12. Building Format Plans only.

I certify that:
* As far as it is practical to determine, no part of the building shown on this plan encroaches onto adjoining lots or road;

~~* Part of the building shown on this plan encroaches onto adjoining lots and road.~~

Cadastral Surveyor/Director * 7.3.08
Date
* delete words not required

7. Portion Allocation :

8. Map Reference :
9542-22441

9. Locality :
PARADISE POINT

10. Local Government :
GOLD COAST CITY COUNCIL

11. Passed & Endorsed :
By: B.B.H. PTY. LTD. ACN 010 427 531
Date: 6.2.08 - 7.3.08
Signed:
Designation: Cadastral Surveyor

13. Lodgement Fees :

Survey Deposit	\$
Lodgement	\$
New Titles	\$
Photocopy	\$
Postage	\$
TOTAL	\$

14. Insert Plan Number
SP199720

LEVEL A

(Basement Level)
Scale 1:300

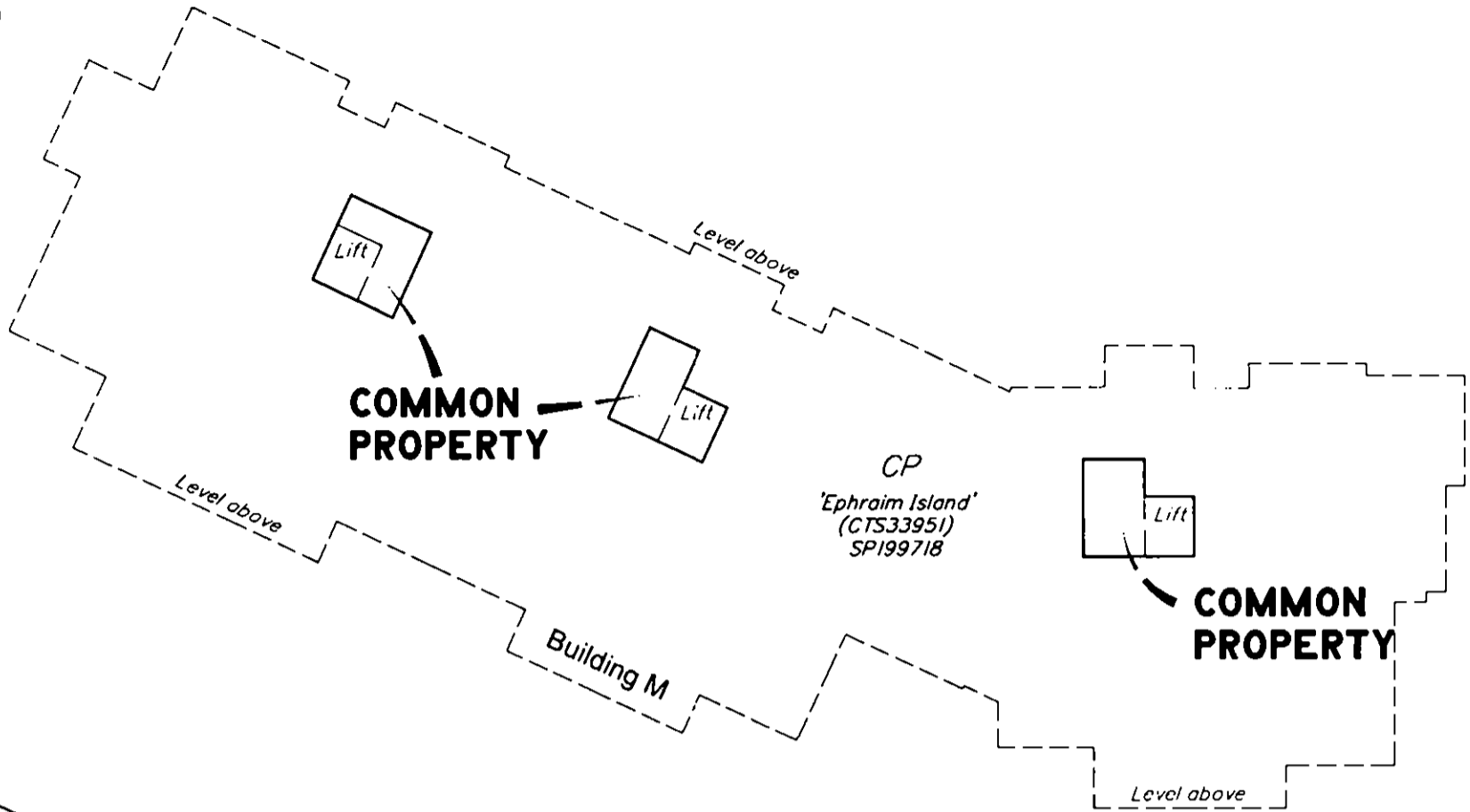

LEVEL B

(Level 1)
Scale 1:300

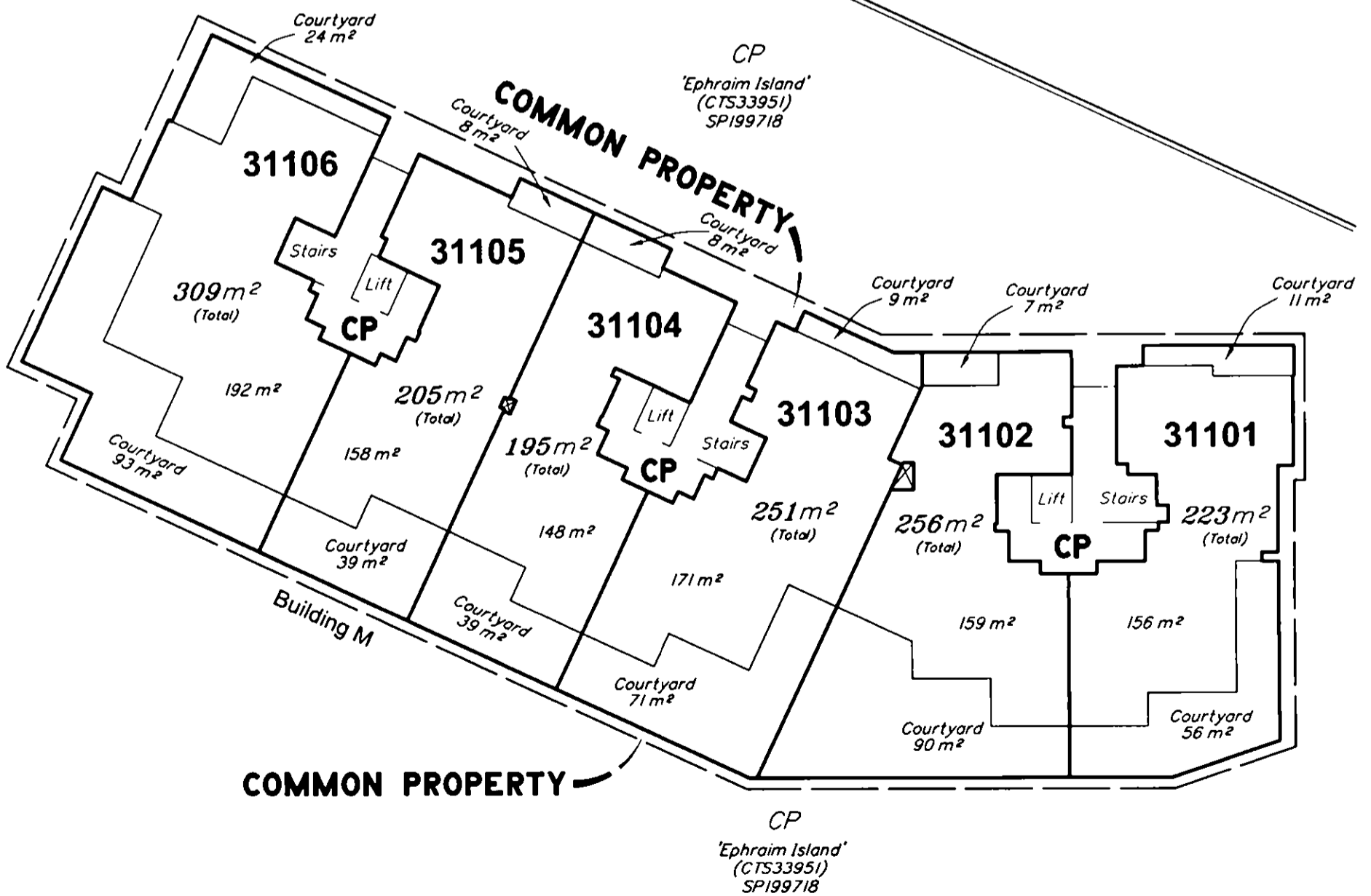

☒ denotes Common Property

SCALE 1:300



State copyright reserved.

Insert Plan Number **SP199720**

BENNETT & BENNETT 02.067 (020678FF8_B.DWG) MCH Rev.B 30/1/08

LEVEL C

(Level 2)
Scale 1:300

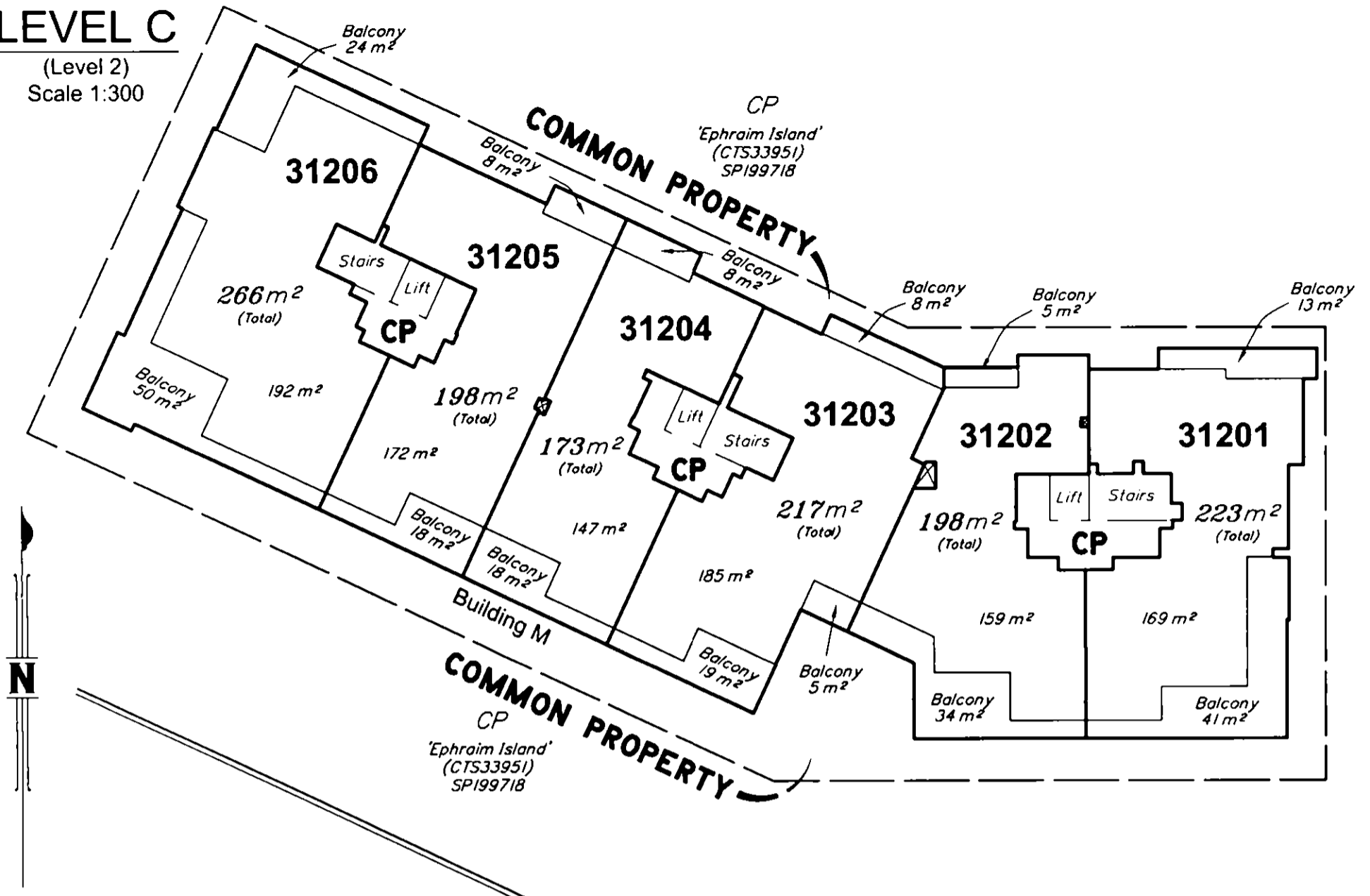

LEVEL D

(Level 3)
Scale 1:300

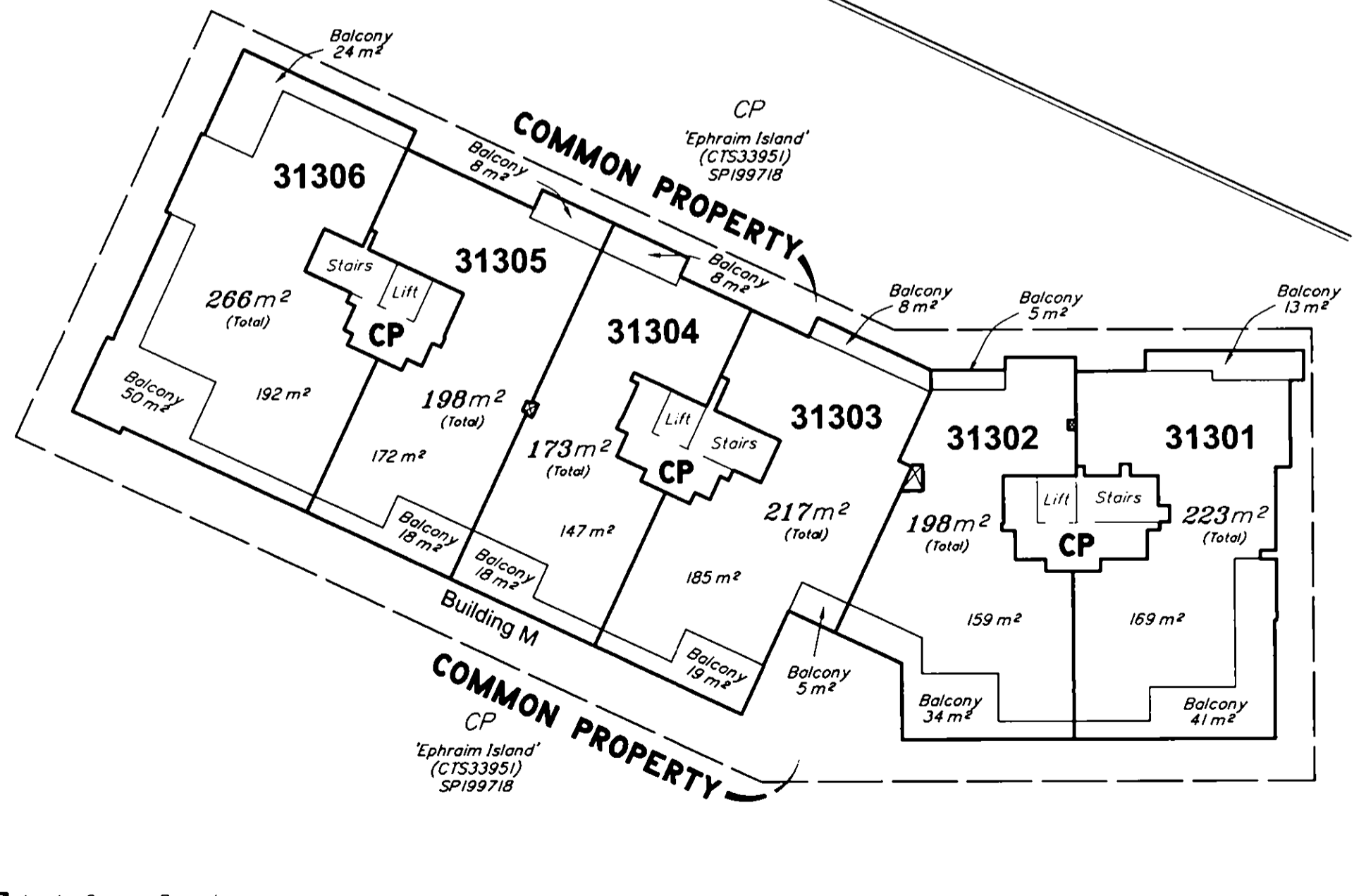

☒ denotes Common Property

SCALE 1:300



State copyright reserved.

Insert Plan Number **SP199720**

BENNETT & BENNETT 02.067 (02067BFP8_B.DWG) MCH Rev.B 30/1/08

LEVEL E

(Level 4)
Scale 1:300

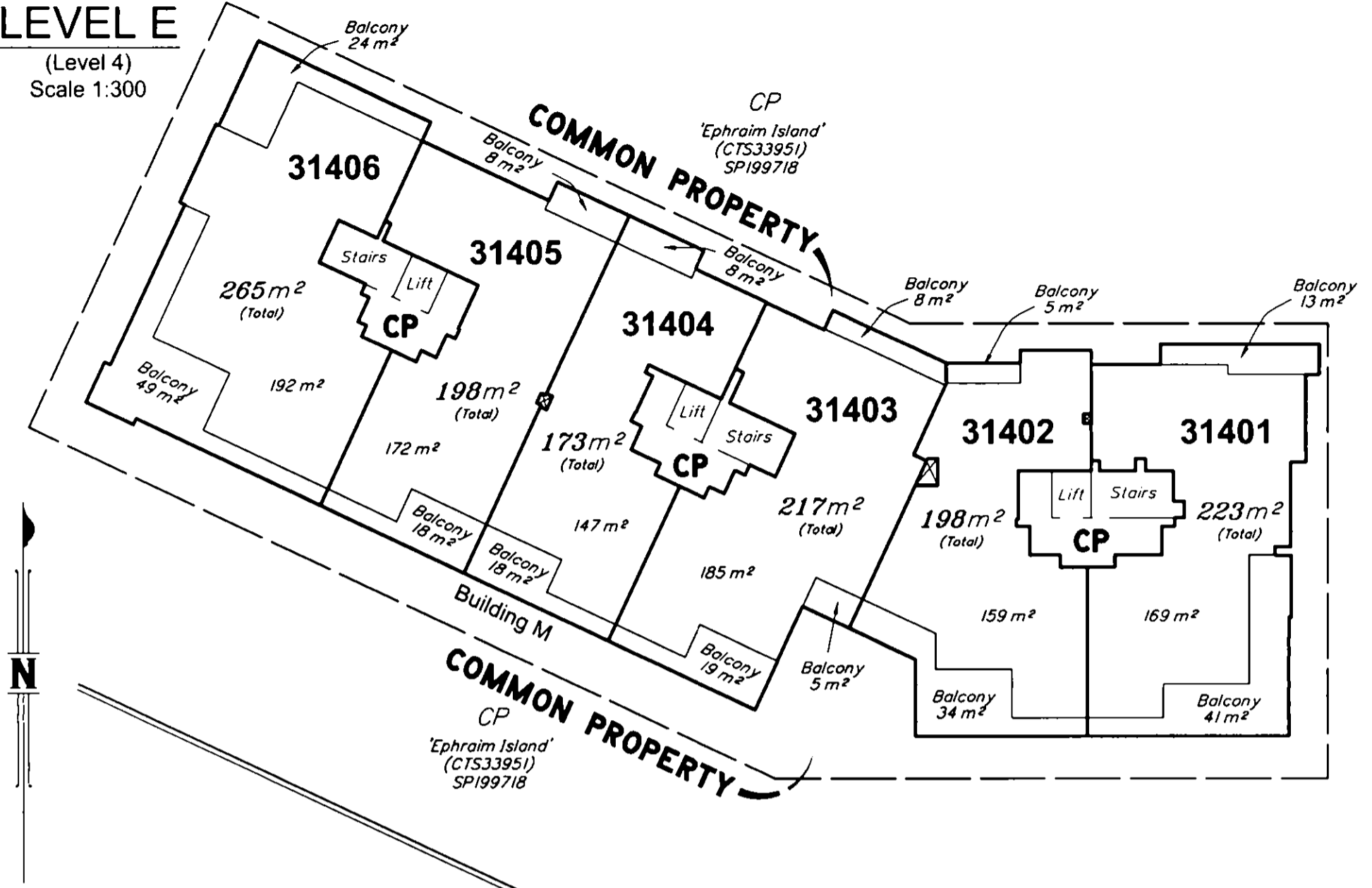

LEVEL F

(Level 5)
Scale 1:300

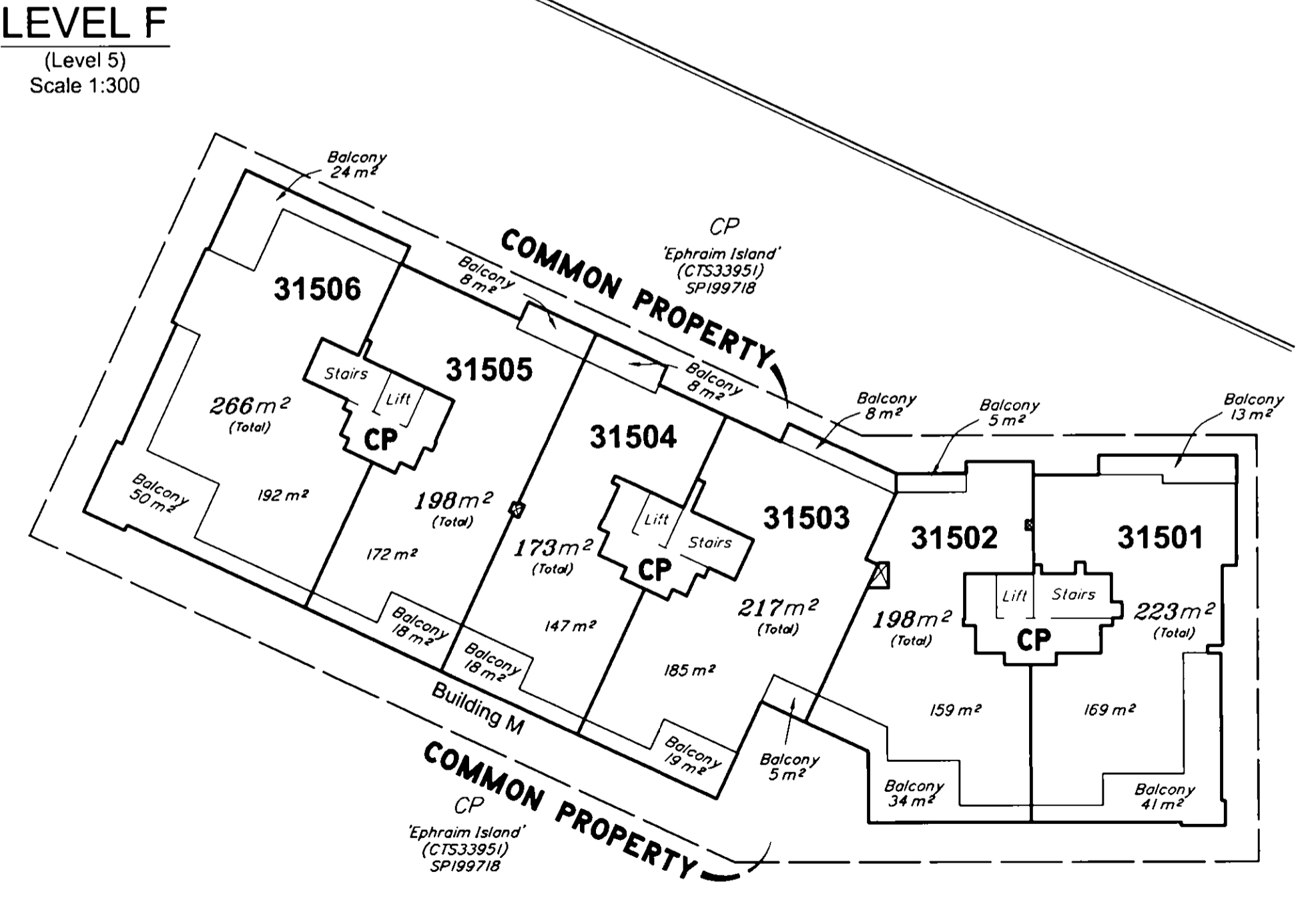

☒ denotes Common Property

SCALE 1:300



State copyright reserved.

Insert Plan Number **SP199720**

LEVEL G

(Level 6)
Scale 1:300

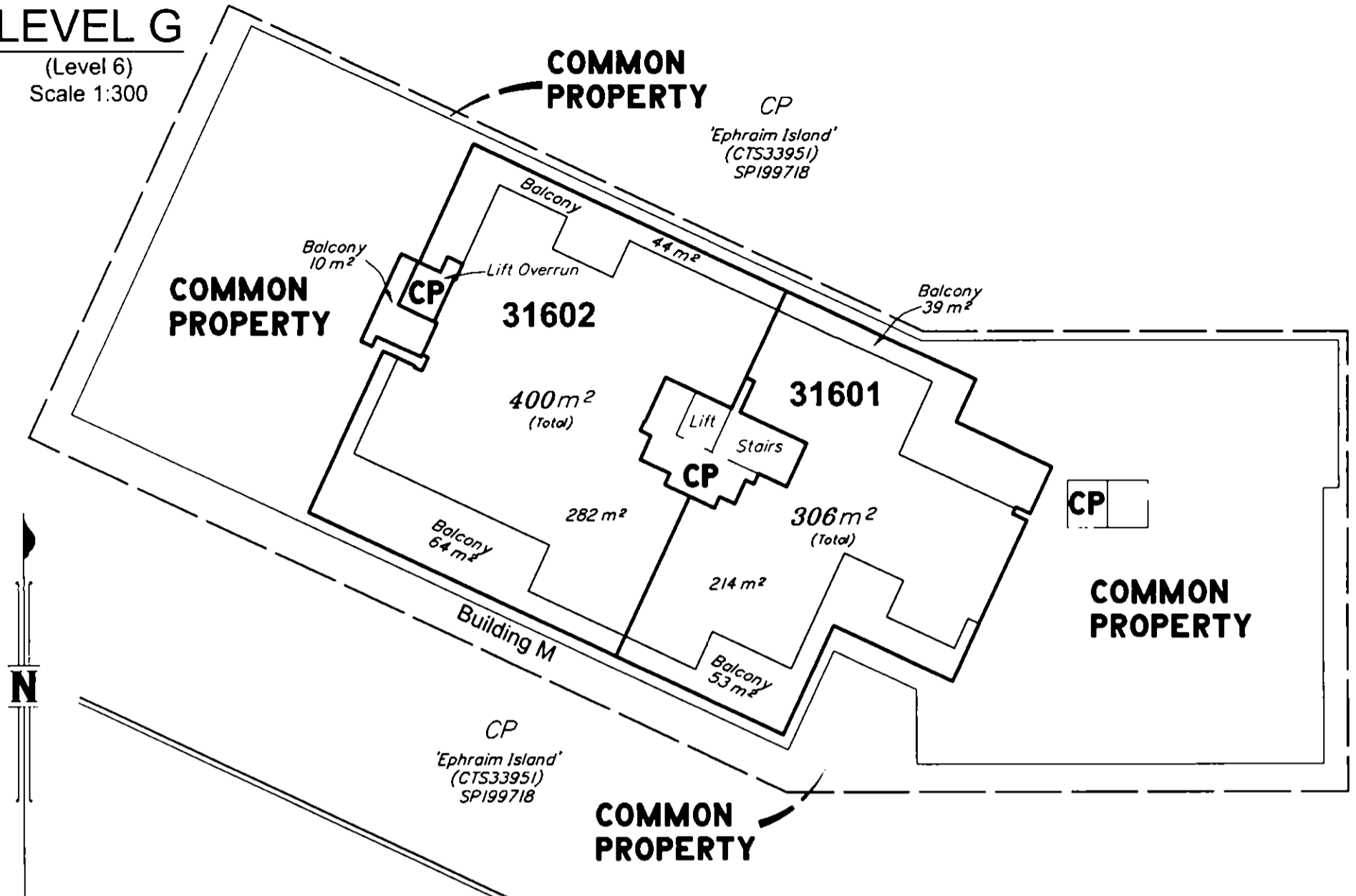

LEVEL H

(Level 7)
Scale 1:300

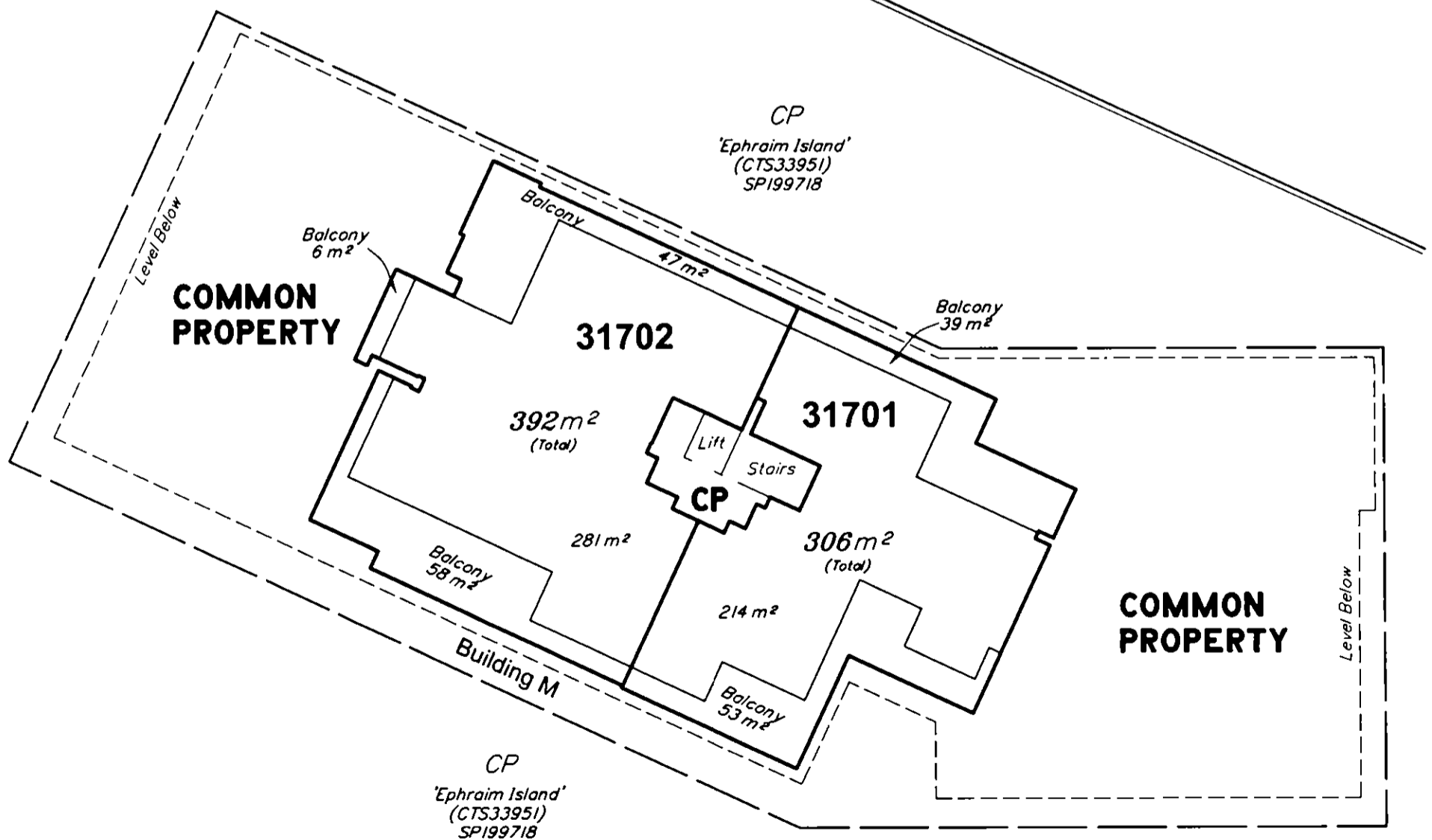

SCALE 1:300

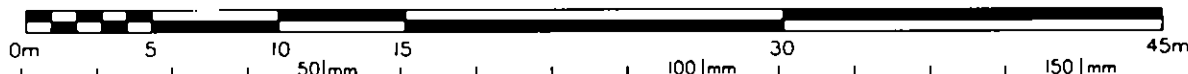

State copyright reserved.

Insert Plan Number **SP199720**

LEVEL I

(Level 8)
Scale 1:300

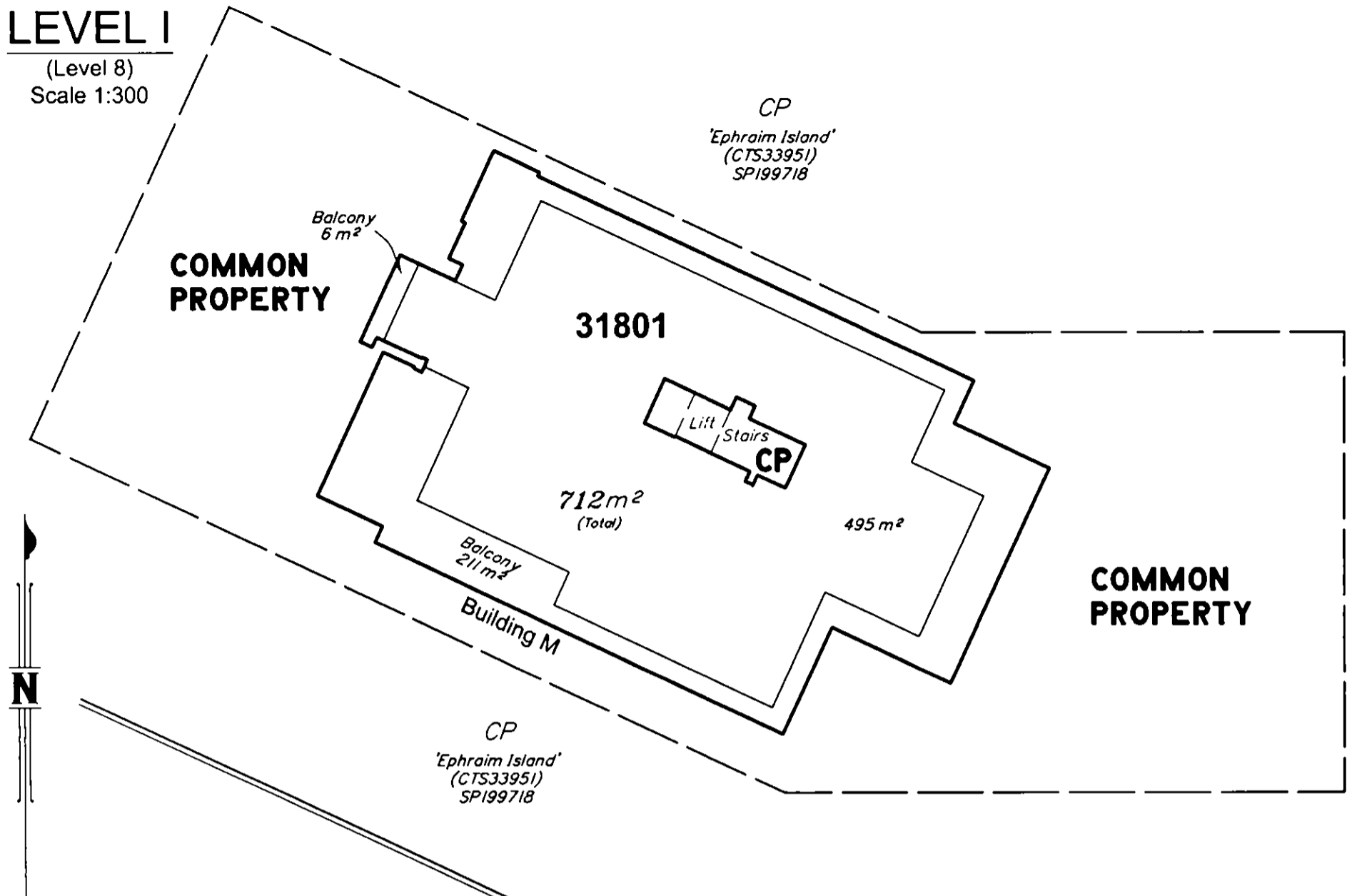

LEVEL J

(Roof Level)
Scale 1:300

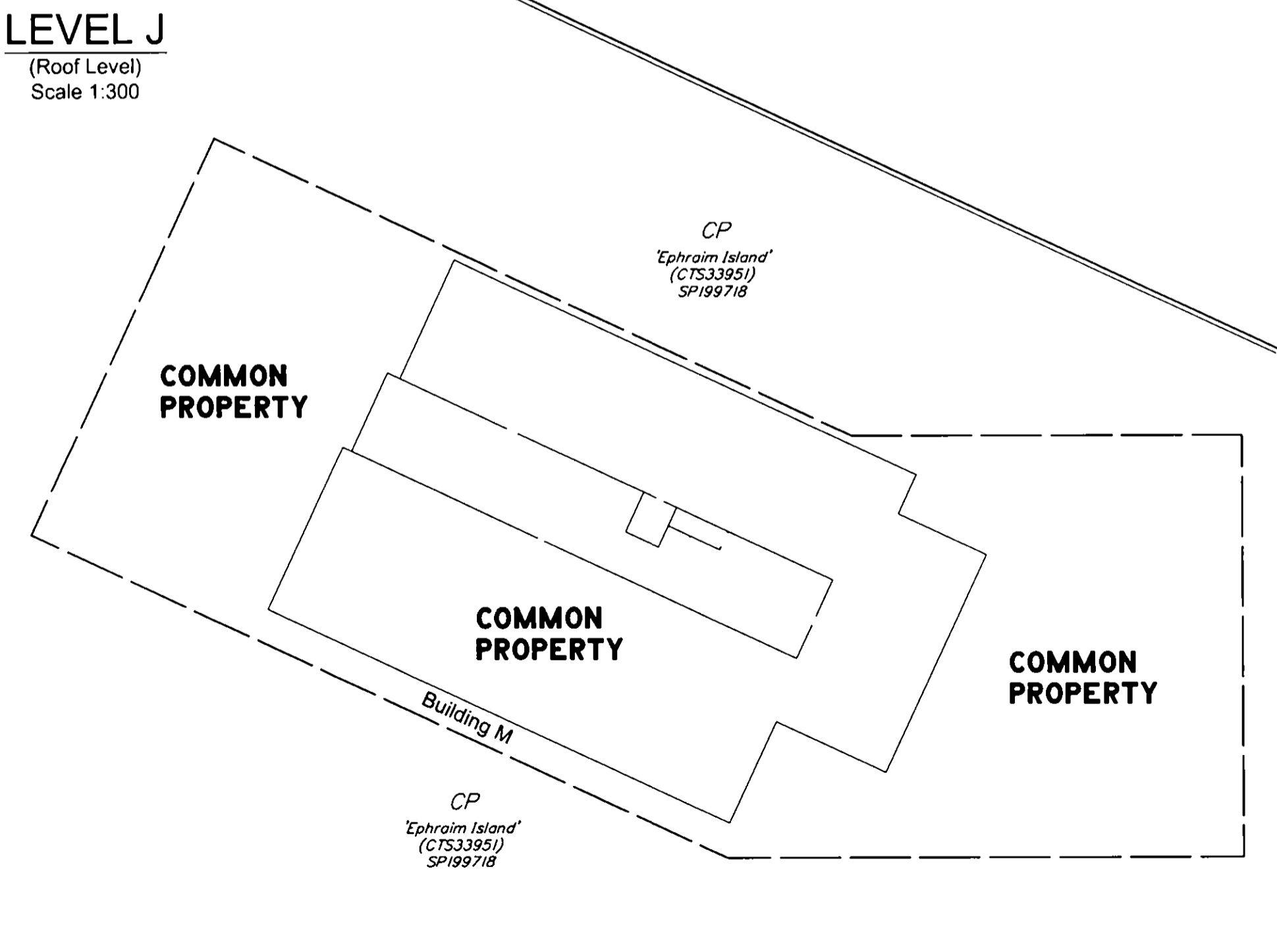

SCALE 1:300



State copyright reserved.

Insert Plan Number **SP199720**